

B | BRAUN

INSTRUÇÕES DE USO – Fio de Sutura Absorvível Monosyn®

Denominação Comercial: Fio de Sutura Absorvível Monosyn®

Denominação técnica: Fio de Sutura

FABRICADO POR:

B BRAUN SURGICAL S. A.
Carretera de Terrassa, 121
08191 Rubi – Barcelona
Espanha

IMPORTADO E DISTRIBUÍDO POR:

B | BRAUN

Laboratórios B|Braun S/A
Av. Eugênio Borges, 1092 e Av. Jequitibá, 09
São Gonçalo – RJ – Brasil
CEP: 24751-000
Farm. Resp.: Rosane G. Ramos da Costa - CRF-RJ nº
3213
Registro ANVISA nº: 80136990513
CNPJ: 31.673.254/0001-02
SAC: 0800-0227286 (Serviço de Atendimento ao Cliente)

DESCRIÇÃO DETALHADA DO PRODUTO MÉDICO



Monosyn® (vide figura abaixo) é uma sutura cirúrgica estéril constituída de fio cirúrgico monofilamentar, sintético, absorvível a médio prazo, produzido a partir de um copolímero composto de Gliconato (72% de Glicólídeo, 14% de e-Caprolactona e 14% Trimetilenocarbonato). Pode ser apresentado tanto na coloração undyed (natural) como violeta D & C Violet nº 2 (aprovado pela FDA). Cumpre todos os requisitos da farmacopéia europeia e da farmacopéia dos Estados Unidos para suturas monofilamentares sintéticas absorvíveis estéreis, exceto a menor variação no diâmetro da sutura.

Oferece excelentes propriedades de manuseio e alta segurança de nó. É recomendado para aproximação de todos os tecidos moles. Está montado em agulhas Easyslide (fácil deslizamento) fabricadas com aço inoxidável (x 40 Cr 13, nº 1.4031 de acordo com DIN 17440) que lhes confere grande capacidade de penetração inicial e repetida assim como uma grande resistência a rotura e ao dobramento.

B | BRAUN

INSTRUÇÕES DE USO – Fio de Sutura Absorvível Monosyn®

COMPOSIÇÃO

Fio: Terpolímero de Glicólideo 72%, e-Caprolactona 14% e Trimetilenocarbonato 14%

Catalizador: sal de ácido 2-etilexanoico de estanho (II)

Iniciador: Dietilenoglicol

Ponto de fusão: 195+/-10°

Estrutura: Monofilar

Corante: D&C Violet nº2 (aprovado pela FDA)

Agulhas: As agulhas são fabricadas com aço inoxidável

FUNDAMENTOS DO FUNCIONAMENTO

É ideal para áreas de feridas infectadas onde a possibilidade de infecção é uma preocupação. Após aplicação no corpo humano, é gradualmente degradado por enzimas autógenas e posteriormente absorvido à medida que a ferida cirúrgica cicatriza. Retém 50% da resistência à tração no nó inicial por até 14 dias após a implantação. Seu período de resistência útil é de 16 a 18 dias e completa absorção de 60 a 90 dias.

Materiais de Sutura são usados, primeiramente, para a adaptação das bordas da ferida para possibilitar uma recuperação sem maiores preocupações. Quando os materiais de sutura são implementados, ocorre uma reação inflamatória mínima do tecido, a qual é tipicamente uma reação endógena à corpos estranhos, seguida por uma encapsulação do material da sutura por tecido conjuntivo fibroso. O ácido glicólico de MONOSYN é metabolizado por hidrólise, sem provocar qualquer reação na região da ferida.

O tipo de fio de sutura absorvível depende do tipo de procedimento cirúrgico, da idade do paciente e do tempo de permanência do fio no corpo humano.

Descrição

- O produto é esterilizado por Óxido de Etileno.
- Primeiramente, os fios são acondicionados em um envelope que tem um lado de PVC transparente ou alumínio e contra-selada com uma lâmina combinada de papel – poliéster / polietileno grau cirúrgico. Este acondicionamento é realizado em máquinas próprias semi-automáticas. O produto é embalado individualmente, em envelope e acondicionados em caixas de cartolina.

O calibre dos fios são os seguintes:

- USP nº 8/0 – 7/0 – 6/0 – 5/0 – 4/0 – 3/0 – 2/0 – 0 – 1 – 2 e 3. Medindo 30 cm, 45 cm, 75 cm, 90 cm e 1,50 m de comprimento.

As agulhas são:

- Forma: 1/2, 3/8, 5/8, e 1/4 de círculo, corpo redondo e reto;
- Pontas: cilíndricas, triangular ou cortante, romba e espatulada.



INSTRUÇÕES DE USO – Fio de Sutura Absorvível Monosyn®

IDENTIFICAÇÃO E RASTREABILIDADE

A identificação e a rastreabilidade deste produto são feitas por número de lote.

INDICAÇÕES

O Fio de Sutura Absorvível Monosyn é destinado ao uso para aproximação e/ou ligação de tecidos moles.

As aplicações típicas são:

- Cirurgia gastrointestinal
- Ginecologia e Obstetrícia
- Urologia
- Cirurgia Plástica e reconstrutiva
- Fechamento epitelial
- Ligaduras

CONTRA-INDICAÇÕES

São contra-indicados para indicações onde o suporte prolongado do fechamento da ferida é exigido, como cirurgia cardiovascular e neurocirurgia, e reparação de tendões.

PRECAUÇÕES

- O produto não deve ser usado, onde de acordo com a prática cirúrgica, materiais de suturas não absorvíveis devem ser necessários.
- O produto só deverá ser utilizado se a embalagem estiver íntegra.
- Descarte as suturas que se encontrem em embalagens abertas.
- Não reesterilize o produto em hipótese nenhuma.
- O produto só deverá ser utilizado por profissionais familiarizados com os procedimentos e técnicas de suturas cirúrgicas, envolvendo o uso de materiais de suturas absorvíveis.
 - Recomenda-se cuidados convenientes e atenção no manuseio do material de sutura em questão, a fim de evitar danos.
 - Ao utilizar pinças e porta agulhas deve se ter o cuidado de garantir que os fios não sejam dobrados ou mesmos esmagados, danificando-se.
 - Observar o prazo de validade indicado na embalagem do produto, não utilizar após o vencimento.
 - A segurança do nó é alcançada como em qualquer tipo de material de sutura, com um nó adequado e laços adicionais. Este é um método confiável a ser usado de acordo com as circunstâncias e a experiência do cirurgião.
 - Manter o produto em local limpo e seco, com cuidados necessários para que a embalagem permaneça íntegra.
 - Estes produtos somente devem ser utilizados por usuários familiarizados com estes procedimentos e técnicas, uma vez que, o risco de deiscência pode variar de acordo com o local da aplicação do mesmo.
 - As suturas Monosyn devem ser armazenadas à temperatura ambiente e não devem ser expostas por períodos longos à temperaturas extremas.

B | BRAUN

INSTRUÇÕES DE USO – Fio de Sutura Absorvível Monosyn®

ADVERTÊNCIAS

Este produto deve ser armazenado a temperaturas abaixo de 25°C, sem umidade ou exposição direta ao calor. É importante que os usuários do fio de sutura Monosyn esteja familiarizado com procedimentos cirúrgicos e técnicas relativas a suturas absorvíveis (há o risco de deiscência, que pode variar tanto pelo local de aplicação quanto pelo tipo de material utilizado).

Ao se utilizar este produto, são necessários cuidados para assegurar que os instrumentos cirúrgicos usados, tais como pinças ou portas agulhas, não causem danos ao fio de sutura, como dobras e esmagamentos.

MONOSYN não deve ser exposto por períodos longos a temperatura extremas. Além disso, quando estas suturas são utilizadas, também pode ocorrer uma moderada reação inflamatória, a qual é tipicamente uma reação endógena à corpos estranhos. O ácido glicólico de MONOSYN é metabolizado por hidrólise, sem provocar qualquer reação na região da ferida.

O uso de um material de sutura absorvível pode ser inapropriado em pacientes com quaisquer condições que na opinião do cirurgião pode causar ou contribuir para um atraso na cicatrização da ferida. O uso de suturas não absorvíveis suplementares devem ser considerados pelo cirurgião no fechamento do abdômen, tórax, articulações ou outros pontos sujeitos a expansão ou que requeiram um suporte adicional.

POSSÍVEIS EFEITOS ADVERSOS

- Leves inflamações logo após aplicação do produto;
- O contato prolongado com soluções salinas, como urina e bile, pode provocar litíase.

ESCLARECIMENTOS SOBRE O USO DO PRODUTO MÉDICO

Prazo de Validade:

O fabricante garante a validade do produto por 5 anos, desde que mantido em sua embalagem original, não aberta e armazenado em condições climáticas normais. Este produtos pode ser esterilizado a óxido de etileno.

DESCARTE DE PRODUTO INUTILIZADO

Este produto é de uso único, devendo ser descartado após o uso. O seu descarte deve ser realizado com os procedimentos utilizados para resíduos sólidos e perfurocortantes potencialmente infectantes, pois possui potenciais riscos de contaminação biológica. Cada instituição apresenta um procedimento de recolhimento, armazenamento e descarte próprio de seus resíduos sólidos, seguindo as normas estabelecidas, seguindo normas estabelecidas pela Resolução – RDC nº 306 (7/12/2004), que dispõe sobre o Regulamento Técnico para o gerenciamento de resíduos de serviços de saúde.

B | BRAUN

INSTRUÇÕES DE USO – Fio de Sutura Absorvível Monosyn®

CUIDADOS ESPECIAIS NO ARMAZENAMENTO, TRANSPORTE E MANUSEIO

Manter o produto em local com temperatura ambiente não exposto a temperaturas extremas, com temperatura máxima de armazenamento de 20°C e mínima de $\pm 5^{\circ}\text{C}$, limpo, seco, com cuidados necessários para que a embalagem permaneça íntegra. Não pisar ou apoiar outros objetos sobre as embalagens ou imprensá-las lateralmente.

Transportar em ambiente limpo e seco, observando a acomodação das embalagens para que as mesmas não sofram danos, nas mesmas temperaturas informadas acima.

O seu manuseio só deve ser feito por profissionais qualificados e que estejam habituados a usar este tipo de material.

FORMAS DE APRESENTAÇÃO DO PRODUTO MÉDICO

As suturas Monosyn estão disponíveis em USP 2 a 6/0 (5 a 0,7 métrica).

As suturas são fornecidas estéreis, em comprimentos pré cortados e em carretéis de ligação, usando ambas as técnicas de conexão de agulhas removíveis ou permanentes. As caixas contêm 1, 2 ou 3 dúzias.

- Embalagem de abertura direta



Figura 8: Forma de apresentação de Monosyn (Caixa e embalagem individual de abertura direta)

B | BRAUN

INSTRUÇÕES DE USO – Fio de Sutura Absorvível Monosyn®



Figura 9: Forma de apresentação de Monosyn (embalagem individual de abertura direta)

Modelos com Embalagem de Abertura Direta:

CÓDIGO	DESCRIÇÃO	CÓDIGO	DESCRIÇÃO
C0022007	MONOSYN VIOLETA 6/0 (0,7) 70CM HR13 (M)	C0023637	MONOSYN UNDYED 2/0 (3) 45CM DSMP24 (M)
C0022803	MONOSYN VIOLETA 5/0 (1) 70CM 2XHR17 (M)	C0022003	MONOSYN VIOLETA 5/0 (1) 70CM HR17(M)
C0022015	MONOSYN VIOLETA 3/0 (2) 70CM HR22 (M)	C0022412	MONOSYN VIOLETA 6/0 (0,7) 45CM HR22 (M)
C0022915	MONOSYN VIOLETA 3/0 (2) 90CM 2XHR22 (M)	C0022814	MONOSYN VIOLETA 4/0(1,5)70CM 2XHR22 (M)
C0022425	MONOSYN VIOLETA 3/0 (2) 90CM HR26 (M)	C0022026	MONOSYN VIOLETA 2/0 (3) 70CM HR26(M)
C0022824	MONOSYN VIOLETA 4/0(1,5)90CM 2XHR26 (M)	C0022823	MONOSYN VIOLETA 4/0(1,5)70CM 2XHR26 (M)
C0022087	MONOSYN VIOLETA 0 (3,5) 70CM HR26S (M)	C0022084	MONOSYN VIOLETA 4/0 (1,5)70CM HR26S (M)
C0022035	MONOSYN VIOLETA 3/0 (2) 70CM HR30 (M)	C0022486	MONOSYN VIOLETA 2/0 (3) 90CM HR26S(M)
C0022535	MONOSYN VIOLETA 3/0 (2) 90CM 2XHR30 (M)	C0022038	MONOSYN VIOLETA 1 (4) 70CM HR30(M)
C0022445	MONOSYN VIOLETA 3/0 (2) 90CM HR37 (M)	C0022046	MONOSYN VIOLETA 2/0 (3) 70CM HR37(M)
C0022457	MONOSYN VIOLETA 0 (3,5) 90CM HR37S (M)	C0022448	MONOSYN VIOLETA 1 (4) 90CM HR37(M)
C0022467	MONOSYN VIOLETA 0 (3,5) 90CM HR40S(M)	C0022067	MONOSYN VIOLETA 0 (3,5) 70CM HR40S(M)
C0022093	MONOSYN VIOLETA 5/0 (1) 70CM DR18 (M)	C0022076	MONOSYN VIOLETA 2/0 (3) 90CM HR48(M)
C0022106	MONOSYN VIOLETA 2/0 (3) 70CM DR32(M)	C0022100	MONOSYN VIOLETA 3/0 (2) 70CM DR22 (M)
C0022734	MONOSYN VIOLETA	C0022619	MONOSYN VIOLETA 3/0 (2)

B | BRAUN

INSTRUÇÕES DE USO – Fio de Sutura Absorvível Monosyn®

	4/0(1,5)70CM 2XFR26 (M)		70CM FR26 (M)
C0022630	MONOSYN VIOLETA 0 (3,5) 70CM FR40 (M)	C0022729	MONOSYN VIOLETA 3/0 (2) 90CM 2XFR36 (M)
C0022305	MONOSYN VIOLETA 3/0 (2) 70CM HRT26 (M)	C0022324	MONOSYN VIOLETA 4/0 (1,5)70CM HRT17 (M)
C0022516	MONOSYN VIOLETA 2/0 (3) 90CM HRT37(M)	C0022316	MONOSYN VIOLETA 2/0 (3) 70CM HRT37(M)
C0022343	MONOSYN VIOLETA 5/0 (1) 70CM DRT18 (M)	C0022527	MONOSYN VIOLETA 0 (3,5) 90CM HRT40 (M)
C0022377	MONOSYN VIOLETA 0 (3,5) 70CM DRT32 (M)	C0022355	MONOSYN VIOLETA 3/0 (2) 70CM DRT22 (M)
C0023226	MONOSYN UNDYED 2/0 (3) 70CM HS23 (M)	C0023264	MONOSYN UNDYED 4/0 (1,5) 70CM HS18(M)
C0023235	MONOSYN UNDYED 3/0 (2) 70CM HS37 (M)	C0023230	MONOSYN UNDYED 1 (4) 70CM HS26S (M)
C0023258	MONOSYN UNDYED 1 (4) 90CM HS48 (M)	C0023238	MONOSYN UNDYED 1 (4) 70CM HS37 (M)
C0023425	MONOSYN UNDYED 3/0 (2) 70CM DS16 (M)	C0023414	MONOSYN UNDYED 4/0 (1,5) 70CM DS12 (M)
C0023214	MONOSYN UNDYED 4/0 (1,5) 70CM DS24 (M)	C0023403	MONOSYN UNDYED 5/0 (1) 70CM DS19 (M)
C0023279	MONOSYN UNDYED 4/0 (1,5) 70CM GS51 (M)	C0023435	MONOSYN UNDYED 3/0 (2) 70CM DS30 (M)
C0023642	MONOSYN UNDYED 6/0(0,7)45CM DSMP11 (M)	C0023284	MONOSYN UNDYED 4/0 (1,5) 70CM GS60 (M)
C0023614	MONOSYN UNDYED 4/0 (1,5) 45CM DSMP16(M)	C0023603	MONOSYN UNDYED 5/0 (1) 45CM DSMP13(M)
C0023634	MONOSYN UNDYED 4/0(1,5)45CM DSMP24 (M)	C0023625	MONOSYN UNDYED 3/0 (2) 45CM DSMP19 (M)
C0022111	MONOSYN VIOLETA 4/0 (1,5) 70CM DR32(M)	C0023632	MONOSYN UNDYED 4/0(1,5)70CM DSMP24 (M)
C0022008	MONOSYN VIOLETA 5/0 (1) 70CM HR13 (M)	C0022004	MONOSYN VIOLETA 4/0 (1,5) 70CM HR17(M)
C0022804	MONOSYN VIOLETA 4/0(1,5)70CM 2XHR17 (M)	C0022413	MONOSYN VIOLETA 5/0 (1) 45CM HR22 (M)
C0022016	MONOSYN VIOLETA 2/0 (3) 70CM HR22(M)	C0022815	MONOSYN VIOLETA 3/0 (2) 70CM 2XHR22 (M)
C0022024	MONOSYN VIOLETA 4/0 (1,5) 70CM HR26(M)	C0022027	MONOSYN VIOLETA 0 (3,5) 70CM HR26(M)
C0022426	MONOSYN VIOLETA 2/0 (3) 90CM HR26(M)	C0022835	MONOSYN VIOLETA 3/0 (2) 70CM 2XHR26 (M)
C0022825	MONOSYN VIOLETA 3/0 (2) 90CM 2XHR26 (M)	C0022085	MONOSYN VIOLETA 3/0 (2) 70CM HR26S (M)
C0022088	MONOSYN VIOLETA 1 (4) 70CM HR26S(M)	C0022487	MONOSYN VIOLETA 0 (3,5) 90CM HR26S (M)
C0022036	MONOSYN VIOLETA 2/0 (3) 70CM HR30(M)	C0022435	MONOSYN VIOLETA 3/0 (2) 70CM 2XHR30 (M)
C0022536	MONOSYN VIOLETA 2/0 (3) 90CM 2XHR30 (M)	C0022047	MONOSYN VIOLETA 0 (3,5) 70CM HR37(M)
C0022446	MONOSYN VIOLETA 2/0 (3) 90CM HR37(M)	B0022543	MONOSYN VIOLETA 0(3,5)4X45CM HR37 (M) TO
C0022458	MONOSYN VIOLETA 1 (4)	C0022068	MONOSYN VIOLETA 1 (4)

B | BRAUN

INSTRUÇÕES DE USO – Fio de Sutura Absorvível Monosyn®

	90CM HR37S (M)		70CM HR40S(M)
C0022468	MONOSYN VIOLETA 1 (4) 90CM HR40S(M)	C0022077	MONOSYN VIOLETA 0 (3,5) 90CM HR48 (M)
C0022094	MONOSYN VIOLETA 4/0 (1,5) 70CM DR18 (M)	C0022117	MONOSYN VIOLETA 3/0 (2) 70CM DR26 (M)
C0022125	MONOSYN VIOLETA 0 (3,5) 70CM DR32(M)	C0022620	MONOSYN VIOLETA 2/0 (3) 70CM FR26 (M)
C0022735	MONOSYN VIOLETA 3/0 (2) 70CM 2XFR26 (M)	C0022730	MONOSYN VIOLETA 2/0 (3) 90CM 2XFR36 (M)
C0022322	MONOSYN VIOLETA 6/0 (0,7)70CM HRT17 (M)	C0022325	MONOSYN VIOLETA 3/0 (2) 70CM HRT17 (M)
C0022306	MONOSYN VIOLETA 2/0 (3) 70CM HRT26(M)	C0022317	MONOSYN VIOLETA 0 (3,5) 70CM HRT37(M)
C0022517	MONOSYN VIOLETA 0 (3,5) 90CM HRT37 (M)	C0022528	MONOSYN VIOLETA 1 (4) 90CM HRT40 (M)
C0022344	MONOSYN VIOLETA 4/0 (1,5) 70CM DRT18 (M)	C0022365	MONOSYN VIOLETA 3/0 (2) 70CM DRT26 (M)
C0022378	MONOSYN VIOLETA 1 (4) 70CM DRT32 (M)	C0023224	MONOSYN UNDYED 4/0 (1,5) 70CM HS23 (M)
C0023239	MONOSYN UNDYED 3/0 (2) 70CM HS26 (M)	C0023250	MONOSYN UNDYED 2/0 (3) 70CM HS30 (M)
C0023236	MONOSYN UNDYED 2/0 (3) 70CM HS37 (M)	C0023247	MONOSYN UNDYED 0 (3,5) 90CM HS40 (M)
C0023412	MONOSYN UNDYED 6/0 (0,7) 70CM DS12 (M)	C0023423	MONOSYN UNDYED 5/0 (1) 70CM DS16 (M)
C0023204	MONOSYN UNDYED 4/0 (1,5) 45CM DS19(M)	C0023404	MONOSYN UNDYED 4/0 (1,5) 70CM DS19(M)
C0023215	MONOSYN UNDYED 3/0 (2) 70CM DS24(M)	C0023436	MONOSYN UNDYED 2/0 (3) 70CM DS30 (M)
C0023280	MONOSYN UNDYED 3/0 (2) 70CM GS51 (M)	C0023285	MONOSYN UNDYED 3/0 (2) 70CM GS60(M)
C0023643	MONOSYN UNDYED 5/0 (1) 45CM DSMP11(M)	C0023604	MONOSYN UNDYED 4/0 (1,5) 45CM DSMP13(M)
C0023623	MONOSYN UNDYED 5/0 (1) 45CM DSMP19(M)	C0023627	MONOSYN UNDYED 4/0(1,5)70CM DSMP19 (M)
C0023633	MONOSYN UNDYED 3/0 (2) 45CM DSMP24 (M)	C0023635	MONOSYN UNDYED 3/0 (2) 70CM DSMP24 (M)
C0022101	MONOSYN VIOLETA 3/0 (2) 70CM DR32(M)	C0022005	MONOSYN VIOLETA 3/0 (2) 70CM HR17(M)
C0022002	MONOSYN VIOLETA 6/0 (0,7) 70CM HR17 (M)	C0022014	MONOSYN VIOLETA 4/0 (1,5) 70CM HR22 (M)
C0022805	MONOSYN VIOLETA 3/0 (2) 70CM 2XHR17 (M)	C0022914	MONOSYN VIOLETA 4/0(1,5)90CM 2XHR22 (M)
C0022511	MONOSYN VIOLETA 3/0(2)4X45 HR22 TO(M)	C0022028	MONOSYN VIOLETA 1 (4) 70CM HR26(M)
C0022025	MONOSYN VIOLETA 3/0 (2) 70CM HR26(M)	C0022836	MONOSYN VIOLETA 2/0 (3) 70CM 2XHR26 (M)
C0022522	MONOSYN VIOLETA 3/0(2)4X45 HR26 TO(M)	C0022086	MONOSYN VIOLETA 2/0 (3) 70CM HR26S(M)
C0022826	MONOSYN VIOLETA 2/0 (3) 90CM 2XHR26 (M)	C0022488	MONOSYN VIOLETA 1 (4) 90CM HR26S (M)
C0022485	MONOSYN VIOLETA 3/0	C0022436	MONOSYN VIOLETA 2/0 (3)

B | BRAUN

INSTRUÇÕES DE USO – Fio de Sutura Absorvível Monosyn®

	(2) 90CM HR26S (M)		70CM 2XHR30 (M)
C0022037	MONOSYN VIOLETA 0 (3,5) 70CM HR30 (M)	C0022048	MONOSYN VIOLETA 1 (4) 70CM HR37(M)
C0022045	MONOSYN VIOLETA 3/0 (2) 70CM HR37(M)	C0022456	MONOSYN VIOLETA 2/0 (3) 90CM HR37S (M)
C0022447	MONOSYN VIOLETA 0 (3,5) 90CM HR37(M)	C0022466	MONOSYN VIOLETA 2/0 (3) 90CM HR40S(M)
C0022066	MONOSYN VIOLETA 2/0 (3) 70CM HR40S(M)	C0022078	MONOSYN VIOLETA 1 (4) 90CM HR48(M)
B0022548	MONOSYN VI 0(3,5)4X45CM HR40S (M)TO	C0022118	MONOSYN VIOLETA 2/0 (3) 70CM DR26 (M)
C0022110	MONOSYN VIOLETA 4/0 (1,5) 70CM DR22 (M)	C0022621	MONOSYN VIOLETA 0 (3,5) 70CM FR26 (M)
C0022126	MONOSYN VIOLETA 1 (4) 70CM DR32(M)	C0022629	MONOSYN VIOLETA 2/0 (3) 70CM FR40 (M)
C0022736	MONOSYN VIOLET 2/0 (3) 70CM 2XFR26(M)DDP	C0022304	MONOSYN VIOLETA 4/0 (1,5) 70CM HRT26 (M)
C0022323	MONOSYN VIOLETA 5/0 (1) 70CM HRT17 (M)	C0022318	MONOSYN VIOLETA 1 (4) 70CM HRT37(M)
C0022307	MONOSYN VIOLETA 0 (3,5) 70CM HRT26 (M)	C0022333	MONOSYN VIOLETA 1 (4) 90CM HRT48 (M)
C0022518	MONOSYN VIOLETA 1 (4) 90CM HRT37(M)	C0022366	MONOSYN VIOLETA 2/0 (3) 70CM DRT26 (M)
C0022354	MONOSYN VIOLETA 4/0 (1,5) 70CM DRT22 (M)	C0023225	MONOSYN UNDYED 3/0 (2) 70CM HS23 (M)
C0023263	MONOSYN UNDYED 5/0 (1) 70CM HS18 (M)	C0023251	MONOSYN UNDYED 0 (3,5) 70CM HS30 (M)
C0023240	MONOSYN UNDYED 2/0 (3) 70CM HS26 (M)	C0023248	MONOSYN UNDYED 1 (4) 90CM HS40 (M)
C0023237	MONOSYN UNDYED 0 (3,5) 70CM HS37 (M)	C0023424	MONOSYN UNDYED 4/0 (1,5) 70CM DS16 (M)
C0023413	MONOSYN UNDYED 5/0 (1) 70CM DS12 (M)	C0023405	MONOSYN UNDYED 3/0 (2) 70CM DS19(M)
C0023205	MONOSYN UNDYED 3/0 (2) 45CM DS19 (M)	C0023437	MONOSYN UNDYED 0 (3,5) 70CM DS30 (M)
C0023216	MONOSYN UNDYED 2/0 (3) 70CM DS24 (M)	C0023286	MONOSYN UNDYED 2/0 (3) 70CM GS60 (M)
C0023281	MONOSYN UNDYED 2/0 (3) 70CM GS51 (M)	C0023613	MONOSYN UNDYED 5/0 (1) 45CM DSMP16(M)
C0023602	MONOSYN UNDYED 6/0(0,7)45CM DSMP13 (M)	C0023628	MONOSYN UNDYED 3/0 (2) 70CM DSMP19 (M)
C0023624	MONOSYN UNDYED 4/0(1,5)45CM DSMP19 (M)	C0023636	MONOSYN UNDYED 2/0 (3) 70CM DSMP24 (M)

- Embalagem RCP

O sistema de embalagem RacePack® (RCP) consiste principalmente em duas partes, uma bolsa externa e um apoio interno.

B | BRAUN

INSTRUÇÕES DE USO – Fio de Sutura Absorvível Monosyn®

A embalagem externa é uma bolsa de alumínio composta por uma folha de alumínio de baixo e uma folha de cobertura. Esta bolsa serve como uma barreira contra agentes microbianos e agentes externos.

O componente interno é um suporte de enrolamento para a sutura. O suporte de enrolamento pode ser de dois diferentes tipos de acordo com o tamanho da agulha:

- Suporte de plástico: Composto por três partes, uma cobertura (tampa) e duas peças poliméricas (PP e PE).

- Suporte de papelão: Apenas uma peça com um pequeno pedaço de espuma para fixação de agulha pequena quando for necessário.



Figura 10: Forma de apresentação de Monosyn (Caixa e embalagem individual RCP)

Modelos com embalagem RCP:

CÓDIGO	DESCRIÇÃO	CÓDIGO	DESCRIÇÃO
B2022079	MONOSYN VIOLETA 2 (5) 90CM HR48 (M) .RCP	C2023279	MONOSYN UNDYED 4/0(1,5)70CM GS51(M).RCP
B2022269	MONOSYN VIOLETA 2 (5) 90CM HS40 (M) .RCP	C2023280	MONOSYN UNDYED 3/0 (2) 70CM GS51(M).RCP
B2022279	MONOSYN VIOLETA 2 (5) 90CM HS48 (M) .RCP	C2023281	MONOSYN UNDYED 2/0 (3) 70CM GS51 (M).RCP

B | BRAUN

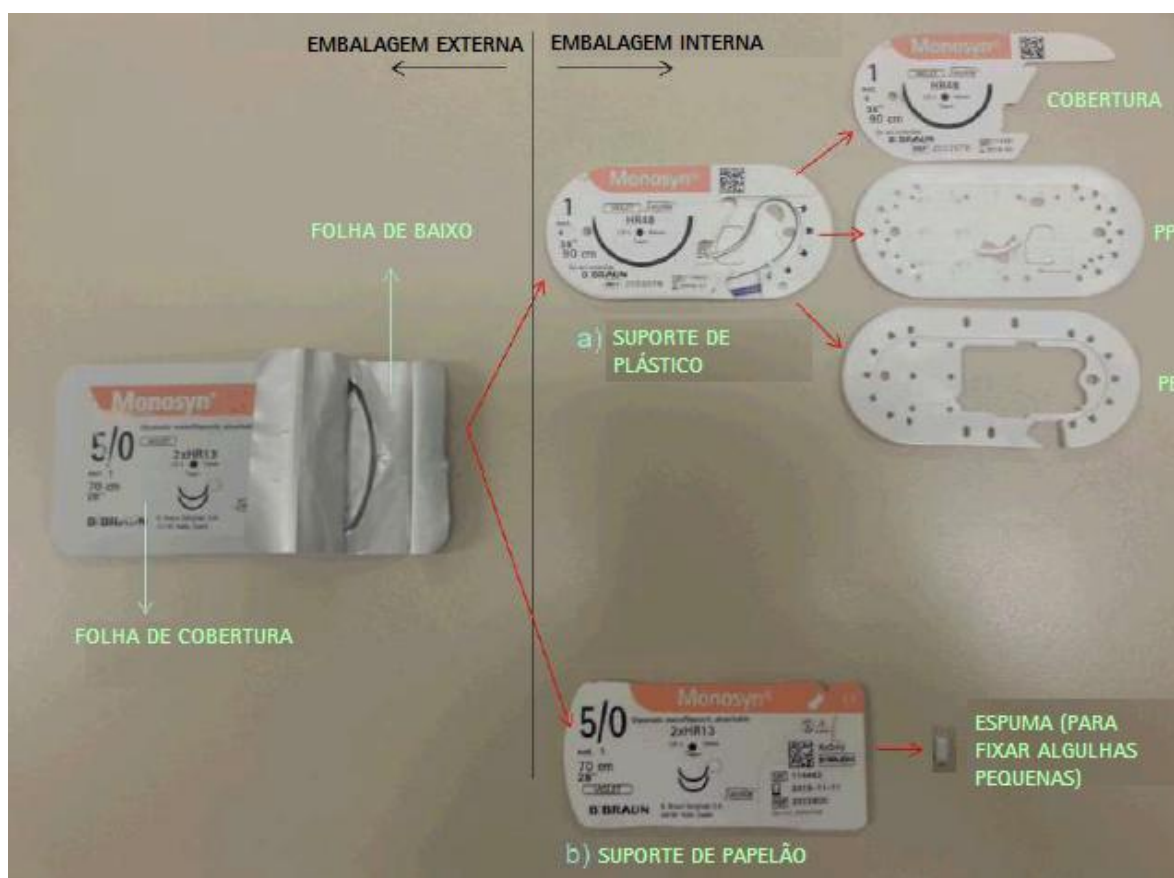
INSTRUÇÕES DE USO – Fio de Sutura Absorvível Monosyn®

B2022290	MONOSYN VIOLETA 1 (4) 140CM HR48 (M) .RCP	C2023284	MONOSYN UNDYED 4/0(1,5)70CM GS60 (M).RCP
B2022292	MONOSYN VIOLETA 0 (3,5) 150CM HR48(M).RCP	C2023285	MONOSYN UNDYED 3/0 (2) 70CM GS60 (M).RCP
B2022298	MONOSYN VIOLETA 2 (5)120CM HS40 (M).RCP	C2023286	MONOSYN UNDYED 2/0 (3) 70CM GS60 (M).RCP
B2022334	MONOSYN VIOLETA 1 (4) 150CMHRC48 (M) .RCP	C2023303	MONOSYN UNDYED 4/0 (1,5)45CM DS16(M).RCP
B2022400	MONOSYN VIOLETA 1 (4) 90CM DRN64 (M) .RCP	C2023403	MONOSYN UNDYED 5/0 (1) 70CM DS19 (M) RCP
B2022453	MONOSYN VIOLETA 1 (4) 90CM HRN50 (M) .RCP	C2023404	MONOSYN UNDYED 4/0(1,5)70CM DS19 (M) RCP
B2022469	MONOSYN VIOLETA 2 (5) 90CM HR40S (M) .RCP	C2023405	MONOSYN UNDYED 3/0 (2) 70CM DS19 (M) RCP
B2022490	MONOSYN VIOLETA 1 (4) 90CM HR60 (M) .RCP	C2023406	MONOSYN UNDYED 2/0 (3) 70CM DS19 (M) RCP
B2022492	MONOSYN VIOLETA 2/0(3)90CM HR65 (M).RCP	C2023412	MONOSYN UNDYED 6/0 (0,7)70CM DS12(M).RCP
B2022493	MONOSYN VIOLETA 1 (4) 90CM HR76 (M) .RCP	C2023413	MONOSYN UNDYED 5/0 (1) 70CM DS12 (M).RCP
B2022494	MONOSYN VIOLETA 2 (5) 150CM HR76 (M) .RCP	C2023414	MONOSYN UNDYED 4/0 (1,5)70CM DS12(M).RCP
B2022575	MONOSYN VIOLETA 2/0 (3)70CM 2XGR65(M).RCP	C2023423	MONOSYN UNDYED 5/0 (1) 70CM DS16 (M).RCP
B2022679	MONOSYN VIOLETA 3/0(2) 90CM GR65 (M) .RCP	C2023424	MONOSYN UNDYED 4/0 (1,5)70CM DS16 (M).RCP
B2022760	MONOSYN VIOLETA 1 (4) 70CM HR70 (M).RCP	C2023425	MONOSYN UNDYED 3/0 (2) 70CM DS16 (M).RCP
C2022002	MONOSYN VIOLETA 6/0 (0,7)70CM HR17(M).RCP	C2023435	MONOSYN UNDYED 3/0 (2) 70CM DS30 (M) RCP
C2022003	MONOSYN VIOLETA 5/0 (1) 70CM HR17 (M).RCP	C2023436	MONOSYN UNDYED 2/0 (3) 70CM DS30 (M) RCP
C2022004	MONOSYN VIOLETA 4/0 (1,5)70CM HR17(M).RCP	C2023437	MONOSYN UNDYED 0 (3,5) 70CM DS30 (M) RCP
C2022005	MONOSYN VIOLETA 3/0 (2) 70CM HR17 (M).RCP	C2023456	MONOSYN UNDYED 2/0 (3) 90CM HR37S (M)RCP
C2022007	MONOSYN VIOLETA 6/0 (0,7)70CM HR13(M).RCP	C2023470	MONOSYN UNDYED 1 (4) 120CM HR37S (M) RCP
C2022008	MONOSYN VIOLETA 5/0 (1) 70CM HR13 (M).RCP	C2023478	MONOSYN UNDYED 1 (4) 120CM HR48 (M) RCP
C2022009	MONOSYN VIOLETA 4/0 (1,5)70CM HR13(M).RCP	C2023479	MONOSYN UNDYED 0 (3,5) 120CM HR48 (M)RCP
C2022013	MONOSYN VIOLETA 5/0 (1) 70CM HR22 (M) RCP	C2023503	MONOSYN UNDYED 5/0 (1) 45CM DS19(M)RCP
C2022014	MONOSYN VIOLETA 4/0 (1,5) 70CM HR22(M)RCP	C2023506	MONOSYN UNDYED 2/0 (3) 45CM DS19(M)RCP
C2022015	MONOSYN VIOLETA 3/0 (2) 70CM HR22 (M) RCP	C2023562	MONOSYN UNDYED 6/0 (0,7)45CM DS16(M).RCP
C2022016	MONOSYN VIOLETA 2/0 (3) 70CM HR22 (M) RCP	C2023563	MONOSYN UNDYED 5/0 (1)45CM DS16(M).RCP
C2022017	MONOSYN VIOLETA 3/0 (2) 30CM HR22 (M).RCP	C2023601	MONOSYN UNDYED 7/0 (0,5)45CM DSMP13M).RCP

B | BRAUN

INSTRUÇÕES DE USO – Fio de Sutura Absorvível Monosyn®

C2022018	MONOSYN VIOLETA 2/0 (3) 30CM HR22(M) .RCP	C2023602	MONOSYN UNDYED 6/0 (0,7)45CM DSMP13M).RCP
C2022022	MONOSYN VIOLETA 3/0 (2) 30CM HR26 (M).RCP	C2023603	MONOSYN UNDYED 5/0 (1) 45CM DSMP13M).RCP
C2022023	MONOSYN VIOLETA 2/0 (3) 30CM HR26 (M).RCP	C2023604	MONOSYN UNDYED 4/0 (1,5)45CM DSMP13M).RCP
C2022024	MONOSYN VIOLETA 4/0 (1,5) 70CM HR26(M)RCP	C2023605	MONOSYN UNDYED 3/0 (2)45CM DSMP13(M).RCP
C2022025	MONOSYN VIOLETA 3/0 (2) 70CM HR26 (M) RCP	C2023608	MONOSYN UNDYED 4/0(1,5)45CM HSMP9(M).RCP
C2022026	MONOSYN VIOLETA 2/0 (3) 70CM HR26 (M) RCP	C2023612	MONOSYN UNDYED 5/0 (1)45CM DSMP16S(M).RCP
C2022027	MONOSYN VIOLETA 0 (3,5) 70CM HR26 (M) RCP	C2023613	MONOSYN UNDYED 5/0 (1)45CM DSMP16(M).RCP
C2022028	MONOSYN VIOLETA 1 (4) 70CM HR26 (M) RCP	C2023614	MONOSYN UNDYED 4/0 (1,5)45CM DSMP16(M).RCP
C2022034	MONOSYN VIOLETA 4/0 (1,5) 70CM HR30(M)RCP	C2023615	MONOSYN UNDYED 4/0 (1,5)45CM HSMP15(M).RCP
C2022035	MONOSYN VIOLETA 3/0 (2) 70CM HR30 (M) RCP	C2023618	MONOSYN UNDYED 0 (3,5) 70CM FR36 (M).RCP
C2022036	MONOSYN VIOLETA 2/0 (3) 70CM HR30 (M) RCP	C2023620	MONOSYN UNDYED 2/0 (3) 70CM FR26 (M).RCP
C2022037	MONOSYN VIOLETA 0 (3,5) 70CM HR30 (M) RCP	C2023622	MONOSYN UNDYED 3/0 (2) 70CM FR26 (M).RCP
C2022038	MONOSYN VIOLETA 1 (4) 70CM HR30 (M) RCP	C2023623	MONOSYN UNDYED 5/0 (1) 45CM DSMP19(M)RCP
C2022039	MONOSYN VIOLETA 2 (5) 70CM HR30 (M).RCP	C2023624	MONOSYN UNDYED 4/0 (1,5)45CM DSMP19(M)RCP
C2022041	MONOSYN VIOLETA 0 (3,5) 70CM HR30S (M)RCP	C2023625	MONOSYN UNDYED 3/0 (2) 45CM DSMP19(M)RCP
C2022042	MONOSYN VIOLETA 1 (4) 70CM HR30S (M) RCP	C2023627	MONOSYN UNDYED 4/0 (1,5)70CM DSMP19(M)RCP
C2022044	MONOSYN VIOLETA 4/0 (1,5) 70CM HR37(M)RCP	C2023628	MONOSYN UNDYED 3/0 (2) 70CM DSMP19(M)RCP
C2022045	MONOSYN VIOLETA 3/0 (2) 70CM HR37 (M) RCP	C2023632	MONOSYN UNDYED 4/0 (1,5)70CM DSMP24(M)RCP
C2022046	MONOSYN VIOLETA 2/0 (3) 70CM HR37 (M) RCP	C2023633	MONOSYN UNDYED 3/0 (2) 45CM DSMP24(M)RCP
C2022047	MONOSYN VIOLETA 0 (3,5) 70CM HR37 (M) RCP	C2023634	MONOSYN UNDYED 4/0 (1,5)45CM DSMP24(M)RCP
C2022048	MONOSYN VIOLETA 1 (4) 70CM HR37 (M) RCP	C2023635	MONOSYN UNDYED 3/0 (2) 70CM DSMP24(M)RCP
C2022049	MONOSYN VIOLETA 2 (5) 70CM HR37 (M) .RCP	C2023636	MONOSYN UNDYED 2/0 (3) 70CM DSMP24(M)RCP
C2022052	MONOSYN VIOLETA 0 (3,5) 90CM HS26S(M)RCP	C2023637	MONOSYN UNDYED 2/0 (3) 45CM DSMP24(M)RCP
C2022053	MONOSYN VIOLETA 2/0 (3) 90CM HS26S(M)RCP	C2023638	MONOSYN UNDYED 3/0 (2)70CM DSMP24S(M)RCP
C2022055	MONOSYN VIOLETA 3/0 (2) 70CM HR37S (M)RCP	C2023641	MONOSYN UNDYED 7/0 (0,5)45CM DSMP11M).RCP
C2022056	MONOSYN VIOLETA 2/0 (3) 70CM HR37S (M)RCP	C2023642	MONOSYN UNDYED 6/0 (0,7)45CM DSMP11M).RCP

B | BRAUN

INSTRUÇÕES DE USO – Fio de Sutura Absorvível Monosyn®

C2022057	MONOSYN VIOLETA 0 (3,5) 70CM HR37S (M)RCP	C2023643	MONOSYN UNDYED 5/0 (1)45CM DSMP11(M).RCP
C2022058	MONOSYN VIOLETA 1 (4) 70CM HR37S (M) RCP	C2023647	MONOSYN UNDYED 7/0(0,5)45CM DSMP7(M).RCP
C2022062	MONOSYN VIOLETA 3/0 (2) 70CM GS60 (M).RCP	C2023651	MONOSYN UNDYED 6/0(0,7)45CM HSMP9(M).RCP
C2022066	MONOSYN VIOLETA 2/0 (3) 70CM HR40S (M)RCP	C2023674	MONOSYN UNDYED 4/0(1,5)30CM 2XHS18M).RCP
C2022067	MONOSYN VIOLETA 0 (3,5) 70CM HR40S(M) RCP	C2023701	MONOSYN UNDYED 3/0 (2) 70CM DGMP19 RCP
C2022068	MONOSYN VIOLETA 1 (4) 70CM HR40S (M) RCP	C2023702	MONOSYN UNDYED 4/0 (1,5) 45CM DGMP13.RCP
C2022069	MONOSYN VIOLETA 2 (5) 70CM HR40S (M) .RCP	C2023703	MONOSYN UNDYED 4/0 (1,5) 45CM DGMP16.RCP
C2022072	MONOSYN VIOLETA 3/0 (2) 90CM HS26(M) RCP	C2023704	MONOSYN UNDYED 4/0 (1,5) 45CM DGMP19 RCP
C2022074	MONOSYN VIOLETA 2/0 (3) 120CM HS26 (M)RCP	C2023705	MONOSYN UNDYED 5/0 (1) 45CM DGMP11 .RCP
C2022075	MONOSYN VIOLETA 2/0 (3) 120CM HS26S(M)RCP	C2023706	MONOSYN UNDYED 5/0 (1) 45CM DGMP13 .RCP
C2022076	MONOSYN VIOLETA 2/0 (3) 90CM HR48 (M) RCP	C2023707	MONOSYN UNDYED 5/0 (1) 45CM DGMP16.RCP
C2022077	MONOSYN VIOLETA 0 (3,5) 90CM HR48 (M) RCP	C2023708	MONOSYN UNDYED 5/0 (1) 45CM DGMP19 RCP
C2022078	MONOSYN VIOLETA 1 (4) 90CM HR48 (M) RCP	C2023709	MONOSYN UNDYED 6/0 (0,7) 45CM DGMP11.RCP
C2022080	MONOSYN VIOLETA 3/0 (2) 120CM HS26(M) RCP	C2023710	MONOSYN UNDYED 6/0 (0,7) 45CM DGMP13.RCP
C2022081	MONOSYN VIOLETA 4/0(1,5)120CM DS19 (M)RCP	C2023711	MONOSYN UNDYED 3/0 (2)70CM DGMP16 DS .RCP
C2022082	MONOSYN VIOLETA 0 (3,5) 120CM HS26S(M)RCP	C2023712	MONOSYN UNDYED 3/0 (2) 45CM DGMP19 RCP
C2022084	MONOSYN VIOLETA 4/0 (1,5)70CM HR26S(M)RCP	C2023713	MONOSYN UNDYED 3/0 (2) 45CM DGMP24 RCP
C2022085	MONOSYN VIOLETA 3/0 (2) 70CM HR26S (M)RCP	C2023717	MONOSYN UNDYED 3/0 (2) 70CM DGMP24 RCP
C2022086	MONOSYN VIOLETA 2/0 (3) 70CM HR26S (M)RCP	C2023915	MONOSYN UNDYED 3/0 (2)90CM 2XHR22(M).RCP
C2022087	MONOSYN VIOLETA 0 (3,5) 70CM HR26S (M)RCP	C2023930	MONOSYN UNDYED 3/0 (2) 90CM HR37S (M)RCP
C2022088	MONOSYN VIOLETA 1 (4) 70CM HR26S (M) RCP	G2022002	MONOSYN VIOLETA 6/0 (0,7)70CM HR17(M).RCP
C2022089	MONOSYN VIOLETA 2 (5) 70CM HR26S (M) .RCP	G2022003	MONOSYN VIOLETA 5/0 (1) 70CM HR17 (M) RCP
C2022093	MONOSYN VIOLETA 5/0 (1) 70CM DR18 (M).RCP	G2022004	MONOSYN VIOLETA 4/0 (1,5) 70CM HR17(M)RCP
C2022094	MONOSYN VIOLETA 4/0(1,5)70CM DR18 (M).RCP	G2022005	MONOSYN VIOLETA 3/0 (2) 70CM HR17 (M) RCP
C2022095	MONOSYN VIOLETA 6/0 (0,7)70CM DR12(M).RCP	G2022008	MONOSYN VIOLETA 5/0 (1) 70CM HR13 (M).RCP
C2022096	MONOSYN VIOLETA 5/0 (1) 70CM DR12 (M).RCP	G2022014	MONOSYN VIOLETA 4/0 (1,5) 70CM HR22(M)RCP

B | BRAUN

INSTRUÇÕES DE USO – Fio de Sutura Absorvível Monosyn®

C2022098	MONOSYN VIOLETA 2/0 (3) 30CM DR22 (M).RCP	G2022015	MONOSYN VIOLETA 3/0 (2) 70CM HR22 (M) RCP
C2022100	MONOSYN VIOLETA 3/0 (2) 70CM DR22 (M) RCP	G2022024	MONOSYN VIOLETA 4/0 (1,5) 70CM HR26(M)RCP
C2022101	MONOSYN VIOLETA 3/0 (2) 70CM DR32 (M) RCP	G2022025	MONOSYN VIOLETA 3/0 (2) 70CM HR26 (M) RCP
C2022102	MONOSYN VIOLETA 6/0 (0,7)45CM DS12(M).RCP	G2022026	MONOSYN VIOLETA 2/0 (3) 70CM HR26 (M) RCP
C2022103	MONOSYN VIOLETA 5/0 (1) 45CM DS12 (M).RCP	G2022027	MONOSYN VIOLETA 0 (3,5) 70CM HR26 (M) RCP
C2022104	MONOSYN VIOLETA 4/0 (1,5)45CM DS12(M).RCP	G2022035	MONOSYN VIOLETA 3/0 (2) 70CM HR30 (M) RCP
C2022106	MONOSYN VIOLETA 2/0 (3) 70CM DR32 (M) RCP	G2022036	MONOSYN VIOLETA 2/0 (3) 70CM HR30 (M) RCP
C2022108	MONOSYN VIOLETA 0 (3,5) 120CM HS37S(M)RCP	G2022037	MONOSYN VIOLETA 0 (3,5) 70CM HR30 (M) RCP
C2022109	MONOSYN VIOLETA 6/0 (0,7)70CM DS12(M).RCP	G2022039	MONOSYN VIOLETA 2 (5) 70CM HR30 (M).RCP
C2022110	MONOSYN VIOLETA 4/0(1,5)70CM DR22 (M)RCP	G2022046	MONOSYN VIOLETA 2/0 (3) 70CM HR37 (M) RCP
C2022111	MONOSYN VIOLETA 4/0 (1,5) 70CM DR32(M)RCP	G2022047	MONOSYN VIOLETA 0 (3,5) 70CM HR37 (M) RCP
C2022112	MONOSYN VIOLETA 3/0 (2) 120CM DR22 (M)RCP	G2022048	MONOSYN VIOLETA 1 (4) 70CM HR37 (M) RCP
C2022115	MONOSYN VIOLETA 3/0 (2) 45CM DS24 (M) RCP	G2022049	MONOSYN VIOLETA 2 (5) 70CM HR37 (M) .RCP
C2022117	MONOSYN VIOLETA 3/0 (2) 70CM DR26 (M) RCP	G2022052	MONOSYN VIOLETA 0 (3,5) 90CM HS26S(M)RCP
C2022118	MONOSYN VIOLETA 2/0 (3) 70CM DR26 (M) RCP	G2022053	MONOSYN VIOLETA 2/0 (3) 90CM HS26S(M)RCP
C2022121	MONOSYN VIOLETA 3/0 (2) 120CM DR26 (M)RCP	G2022067	MONOSYN VIOLETA 0 (3,5) 70CM HR40S(M) RCP
C2022123	MONOSYN VIOLETA 6/0 (0,7)70CM HR10(M).RCP	G2022068	MONOSYN VIOLETA 1 (4) 70CM HR40S (M) RCP
C2022125	MONOSYN VIOLETA 0 (3,5) 70CM DR32 (M) RCP	G2022072	MONOSYN VIOLETA 3/0 (2) 90CM HS26(M) RCP
C2022126	MONOSYN VIOLETA 1 (4) 70CM DR32 (M) RCP	G2022074	MONOSYN VIOLETA 2/0 (3) 120CM HS26 (M)RCP
C2022129	MONOSYN VIOLETA 4/0 (1,5) 120CM DR22 RCP	G2022075	MONOSYN VIOLETA 2/0 (3) 120CM HS26S(M)RCP
C2022132	MONOSYN VIOLETA 7/0 (0,5)45CM HR13(M).RCP	G2022076	MONOSYN VIOLETA 2/0 (3) 90CM HR48 (M) RCP
C2022136	MONOSYN VIOLETA 1 (4) 120CM HS37S (M)RCP	G2022077	MONOSYN VIOLETA 0 (3,5) 90CM HR48 (M) RCP
C2022141	MONOSYN VIOLETA 4/0 (1,5)70CM DSMP19(M)RCP	G2022078	MONOSYN VIOLETA 1 (4) 90CM HR48 (M) RCP
C2022151	MONOSYN VIOLETA 2/0 (3)90CM FR36/FR26M.RCP	G2022079	MONOSYN VIOLETA 2 (5) 90CM HR48 (M) .RCP
C2022204	MONOSYN VIOLETA 4/0(1,5)70CM DS19 (M) RCP	G2022080	MONOSYN VIOLETA 3/0 (2) 120CM HS26(M) RCP
C2022205	MONOSYN VIOLETA 3/0 (2) 70CM DS19 (M) RCP	G2022081	MONOSYN VIOLETA 4/0(1,5)120CM DS19 (M)RCP

B | BRAUN

INSTRUÇÕES DE USO – Fio de Sutura Absorvível Monosyn®

C2022210	MONOSYN VIOLETA 5/0 (1) 70CM DS12 (M).RCP	G2022082	MONOSYN VIOLETA 0 (3,5) 120CM HS26S(M)RCP
C2022214	MONOSYN VIOLETA 4/0 (1,5) 70CM DS24(M)RCP	G2022086	MONOSYN VIOLETA 2/0 (3) 70CM HR26S (M)RCP
C2022215	MONOSYN VIOLETA 3/0 (2) 70CM DS24 (M) RCP	G2022089	MONOSYN VIOLETA 2 (5) 70CM HR26S (M).RCP
C2022216	MONOSYN VIOLETA 2/0 (3) 70CM DS24 (M) RCP	G2022104	MONOSYN VIOLETA 4/0 (1,5)45CM DS12(M).RCP
C2022217	MONOSYN VIOLETA 0 (3,5) 70CM DS24 (M) RCP	G2022108	MONOSYN VIOLETA 0 (3,5) 120CM HS37S(M)RCP
C2022218	MONOSYN VIOLETA 2/0 (3)90CM HR26/FR26M.RCP	G2022110	MONOSYN VIOLETA 4/0(1,5)70CM DR22 (M)RCP
C2022220	MONOSYN VIOLETA 4/0(1,5)70CM DS16 (M).RCP	G2022117	MONOSYN VIOLETA 3/0 (2) 70CM DR26 (M) RCP
C2022225	MONOSYN VIOLETA 3/0 (2) 90CM DS24 (M) RCP	G2022118	MONOSYN VIOLETA 2/0 (3) 70CM DR26 (M) RCP
C2022226	MONOSYN VIOLETA 2/0 (3) 90CM DS24 (M) RCP	G2022132	MONOSYN VIOLETA 7/0 (0,5)45CM HR13(M).RCP
C2022229	MONOSYN VIOLETA 1 (4) 90CM DR48 (M).RCP	G2022136	MONOSYN VIOLETA 1 (4) 120CM HS37S (M) RCP
C2022231	MONOSYN VIOLETA 2/0 (3) 70CM DS30 (M) RCP	G2022204	MONOSYN VIOLETA 4/0(1,5)70CM DS19 (M) RCP
C2022232	MONOSYN VIOLETA 0 (3,5) 70CM DS30 (M) RCP	G2022205	MONOSYN VIOLETA 3/0 (2) 70CM DS19 (M) RCP
C2022233	MONOSYN VIOLETA 1 (4) 70CM DS30 (M) RCP	G2022214	MONOSYN VIOLETA 4/0 (1,5) 70CM DS24(M)RCP
C2022234	MONOSYN VIOLETA 4/0 (1,5)70CM HS18(M).RCP	G2022215	MONOSYN VIOLETA 3/0 (2) 70CM DS24 (M) RCP
C2022236	MONOSYN VIOLETA 3/0 (2) 70CM HS26 (M) RCP	G2022216	MONOSYN VIOLETA 2/0 (3) 70CM DS24 (M) RCP
C2022237	MONOSYN VIOLETA 2/0 (3) 70CM HS26 (M) RCP	G2022217	MONOSYN VIOLETA 0 (3,5) 70CM DS24 (M) RCP
C2022238	MONOSYN VIOLETA 6/0 (0,7)90CM HR17(M).RCP	G2022225	MONOSYN VIOLETA 3/0 (2) 90CM DS24 (M) RCP
C2022239	MONOSYN VIOLETA 2/0 (3) 70CM DS19(M)RCP	G2022226	MONOSYN VIOLETA 2/0 (3) 90CM DS24 (M) RCP
C2022240	MONOSYN VIOLETA 4/0 (1,5) 90CM HR22(M)RCP	G2022231	MONOSYN VIOLETA 2/0 (3) 70CM DS30 (M) RCP
C2022241	MONOSYN VIOLETA 3/0 (2) 70CM HS26S (M)RCP	G2022232	MONOSYN VIOLETA 0 (3,5) 70CM DS30 (M) RCP
C2022242	MONOSYN VIOLETA 2/0 (3) 70CM HS26S (M)RCP	G2022233	MONOSYN VIOLETA 1 (4) 70CM DS30 (M) RCP
C2022243	MONOSYN VIOLETA 0 (3,5) 70CM HS26S (M)RCP	G2022234	MONOSYN VIOLETA 4/0 (1,5) 70CM HS18(M)RCP
C2022246	MONOSYN VIOLETA 3/0 (2) 90CM HR22 (M) RCP	G2022236	MONOSYN VIOLETA 3/0 (2) 70CM HS26 (M) RCP
C2022247	MONOSYN VIOLETA 2/0 (3) 70CM HS37S (M)RCP	G2022237	MONOSYN VIOLETA 2/0 (3) 70CM HS26 (M) RCP
C2022248	MONOSYN VIOLETA 0 (3,5) 70CM HS37S (M)RCP	G2022238	MONOSYN VIOLETA 6/0 (0,7)90CM HR17(M).RCP
C2022249	MONOSYN VIOLETA 1 (4) 70CM HS37S (M) RCP	G2022240	MONOSYN VIOLETA 4/0 (1,5) 90CM HR22(M)RCP

B | BRAUN

INSTRUÇÕES DE USO – Fio de Sutura Absorvível Monosyn®

C2022250	MONOSYN VIOLETA 0 (3,5) 90CM HR26 (M) RCP	G2022241	MONOSYN VIOLETA 3/0 (2) 70CM HS26S (M)RCP
C2022251	MONOSYN VIOLETA 0 (3,5) 90CM DS24 (M) RCP	G2022242	MONOSYN VIOLETA 2/0 (3) 70CM HS26S (M)RCP
C2022252	MONOSYN VIOLETA 2/0 (3) 90CM DS30 (M) RCP	G2022243	MONOSYN VIOLETA 0 (3,5) 70CM HS26S (M)RCP
C2022254	MONOSYN VIOLETA 4/0 (1,5)90CM HS18(M).RCP	G2022246	MONOSYN VIOLETA 3/0 (2) 90CM HR22 (M) RCP
C2022255	MONOSYN VIOLETA 2/0 (3) 90CM HRC26(M) RCP	G2022247	MONOSYN VIOLETA 2/0 (3) 70CM HS37S (M)RCP
C2022256	MONOSYN VIOLETA 2/0 (3) 70CM HS37SS(M)RCP	G2022248	MONOSYN VIOLETA 0 (3,5) 70CM HS37S (M)RCP
C2022257	MONOSYN VIOLETA 6/0(0,7)120CM HR17(M).RCP	G2022249	MONOSYN VIOLETA 1 (4) 70CM HS37S (M) RCP
C2022259	MONOSYN VIOLETA 5/0 (1)120CM HR17 (M).RCP	G2022250	MONOSYN VIOLETA 0 (3,5) 90CM HR26 (M) RCP
C2022262	MONOSYN VIOLETA 4/0(1,5)120CM HR17(M).RCP	G2022251	MONOSYN VIOLETA 0 (3,5) 90CM DS24 (M) RCP
C2022263	MONOSYN VIOLETA 4/0 (1,5)120CM HR22(M)RCP	G2022252	MONOSYN VIOLETA 2/0 (3) 90CM DS30 (M) RCP
C2022264	MONOSYN VIOLETA 3/0 (2)120CM DS19 (M) RCP	G2022254	MONOSYN VIOLETA 4/0 (1,5)90CM HS18(M).RCP
C2022267	MONOSYN VIOLETA 3/0 (2)120CM DS24 (M) RCP	G2022255	MONOSYN VIOLETA 2/0 (3) 90CM HRC26(M) RCP
C2022269	MONOSYN VIOLETA 2 (5) 90CM HS40 (M) .RCP	G2022257	MONOSYN VIOLETA 6/0(0,7)120CM HR17(M).RCP
C2022283	MONOSYN VIOLETA 2/0 (3) 70CM HRN35 (M)RCP	G2022259	MONOSYN VIOLETA 5/0 (1)120CM HR17 (M).RCP
C2022284	MONOSYN VIOLETA 0 (3,5) 70CM HRN35 (M)RCP	G2022262	MONOSYN VIOLETA 4/0(1,5)120CM HR17(M).RCP
C2022286	MONOSYN VIOLETA 2/0 (3)120CM DS24 (M) RCP	G2022263	MONOSYN VIOLETA 4/0 (1,5)120CM HR22(M)RCP
C2022289	MONOSYN VIOLETA 0 (3,5)120CM DS24 (M) RCP	G2022264	MONOSYN VIOLETA 3/0 (2)120CM DS19 (M) RCP
C2022291	MONOSYN VIOLETA 2/0 (3)120CM DS30 (M) RCP	G2022267	MONOSYN VIOLETA 3/0 (2)120CM DS24 (M) RCP
C2022293	MONOSYN VIOLETA 0 (3,5)120CM DS30 (M) RCP	G2022269	MONOSYN VIOLETA 2 (5) 90CM HS40 (M) .RCP
C2022295	MONOSYN VIOLETA 4/0(1,5)120CM HS18(M).RCP	G2022279	MONOSYN VIOLETA 2 (5) 90CM HS48 (M) .RCP
C2022296	MONOSYN VIOLETA 2/0 (3)20CM 2XHR26(M).RCP	G2022286	MONOSYN VIOLETA 2/0 (3)120CM DS24 (M) RCP
C2022297	MONOSYN VIOLETA 2/0 (3)120CM HS37S (M)RCP	G2022289	MONOSYN VIOLETA 0 (3,5)120CM DS24 (M) RCP
C2022299	MONOSYN VIOLETA 2/0 (3) 90CM HS26 (M) RCP	G2022291	MONOSYN VIOLETA 2/0 (3)120CM DS30 (M) RCP
C2022300	MONOSYN VIOLETA 2/0 (3)120CM HRC26(M) RCP	G2022293	MONOSYN VIOLETA 0 (3,5)120CM DS30 (M) RCP
C2022301	MONOSYN VIOLETA 6/0(0,7)70CM HR13B(M).RCP	G2022295	MONOSYN VIOLETA 4/0(1,5)120CM HS18(M).RCP
C2022304	MONOSYN VIOLETA 4/0(1,5) 70CM HRC26(M)RCP	G2022297	MONOSYN VIOLETA 2/0 (3)120CM HS37S (M)RCP

B | BRAUN

INSTRUÇÕES DE USO – Fio de Sutura Absorvível Monosyn®

C2022305	MONOSYN VIOLETA 3/0 (2) 70CM HRC26 (M)RCP	G2022299	MONOSYN VIOLETA 2/0 (3) 90CM HS26 (M) RCP
C2022306	MONOSYN VIOLETA 2/0 (3) 70CM HRC26 (M)RCP	G2022300	MONOSYN VIOLETA 2/0 (3)120CM HRC26(M) RCP
C2022307	MONOSYN VIOLETA 0 (3,5) 70CM HRC26 (M)RCP	G2022304	MONOSYN VIOLETA 4/0(1,5) 70CM HRC26(M)RCP
C2022308	MONOSYN VIOLETA 1 (4) 70CM HRC26 (M) RCP	G2022305	MONOSYN VIOLETA 3/0 (2) 70CM HRC26 (M)RCP
C2022309	MONOSYN VIOLETA 2 (5) 70CM HS40 (M).RCP	G2022306	MONOSYN VIOLETA 2/0 (3) 70CM HRC26 (M)RCP
C2022310	MONOSYN VIOLETA 6/0(0,7) 70CMHRC13(M).RCP	G2022307	MONOSYN VIOLETA 0 (3,5) 70CM HRC26 (M)RCP
C2022311	MONOSYN VIOLETA 5/0 (1) 70CMHRC13 (M).RCP	G2022309	MONOSYN VIOLETA 2 (5) 70CM HS40 (M) RCP
C2022314	MONOSYN VIOLETA 3/0 (2) 90CM HRC37S(M)RCP	G2022322	MONOSYN VIOLETA 6/0(0,7) 70CMHRC17(M).RCP
C2022315	MONOSYN VIOLETA 3/0 (2) 70CM HRC37S(M)RCP	G2022323	MONOSYN VIOLETA 5/0 (1) 70CMHRC17 (M).RCP
C2022316	MONOSYN VIOLETA 2/0 (3) 70CM HRC37S(M)RCP	G2022324	MONOSYN VIOLETA 4/0(1,5) 70CMHRC17(M).RCP
C2022317	MONOSYN VIOLETA 0 (3,5) 70CM HRC37S(M)RCP	G2022325	MONOSYN VIOLETA 3/0 (2) 70CMHRC17 (M).RCP
C2022318	MONOSYN VIOLETA 1 (4) 70CM HRC37S (M) RCP	G2022349	MONOSYN VIOLETA 0 (3,5) 90CM DS30 (M) RCP
C2022322	MONOSYN VIOLETA 6/0(0,7) 70CMHRC17(M).RCP	G2022404	MONOSYN VIOLETA 4/0 (1,5)70CM2XHRC26(M).RCP
C2022323	MONOSYN VIOLETA 5/0 (1) 70CMHRC17 (M).RCP	G2022419	MONOSYN VIOLETA 5/0 (1) 45CM DS16 (M) RCP
C2022324	MONOSYN VIOLETA 4/0(1,5) 70CMHRC17(M).RCP	G2022422	MONOSYN VIOLETA 4/0 (1,5) 90CM HR26(M)RCP
C2022325	MONOSYN VIOLETA 3/0 (2) 70CMHRC17 (M).RCP	G2022424	MONOSYN VIOLETA 3/0 (2) 120CM HR26 (M)RCP
C2022326	MONOSYN VIOLETA 2/0 (3) 70CMHRC17 (M).RCP	G2022425	MONOSYN VIOLETA 3/0 (2)90CM HR26 (M) RCP
C2022330	MONOSYN VIOLETA 4/0 (1,5)70CM2XHRC22(M).RCP	G2022426	MONOSYN VIOLETA 2/0 (3)90CM HR26 (M) RCP
C2022331	MONOSYN VIOLETA 3/0 (2)70CM 2XHRC22(M).RCP	G2022433	MONOSYN VIOLETA 5/0 (1)45CM DSMP13(M).RCP
C2022332	MONOSYN VIOLETA 0 (3,5) 90CM HRC48 (M)RCP	G2022446	MONOSYN VIOLETA 2/0 (3) 90CM HR37 (M) RCP
C2022333	MONOSYN VIOLETA 1 (4) 90CM HRC48 (M) RCP	G2022448	MONOSYN VIOLETA 1 (4) 90CM HR37 (M) RCP
C2022335	MONOSYN VIOLETA 3/0 (2) 70CM HRC30S(M)RCP	G2022461	MONOSYN VIOLETA 2/0 (3) 90CM HS37S(M).RCP
C2022336	MONOSYN VIOLETA 2/0 (3) 70CM HRC30S(M)RCP	G2022467	MONOSYN VIOLETA 0 (3,5) 90CM HR40S(M) RCP
C2022337	MONOSYN VIOLETA 0 (3,5) 70CM HRC30S(M)RCP	G2022468	MONOSYN VIOLETA 1 (4) 90CM HR40S (M) RCP
C2022338	MONOSYN VIOLETA 1 (4) 70CM HRC30S (M) RCP	G2022504	MONOSYN VIOLETA 4/0(1,5)45CM DS19 (M) RCP
C2022343	MONOSYN VIOLETA 5/0 (1) 70CMDRC18 (M).RCP	G2022516	MONOSYN VIOLETA 2/0 (3) 90CM HRC37S(M)RCP

B | BRAUN

INSTRUÇÕES DE USO – Fio de Sutura Absorvível Monosyn®

C2022344	MONOSYN VIOLETA 4/0(1,5) 70CMDRC18(M).RCP	G2022517	MONOSYN VIOLETA 0 (3,5) 90CM HRC37S(M)RCP
C2022349	MONOSYN VIOLETA 0 (3,5) 90CM DS30 (M) RCP	G2022518	MONOSYN VIOLETA 1 (4) 90CM HRC37S (M) RCP
C2022354	MONOSYN VIOLETA 4/0(1,5) 70CM DRC22(M)RCP	G2022519	MONOSYN VIOLETA 3/0 (2) 120CM HR22 (M)RCP
C2022355	MONOSYN VIOLETA 3/0 (2) 70CM DRC22 (M)RCP	G2022524	MONOSYN VIOLETA 4/0(1,5)120CM HR26 (M)RCP
C2022357	MONOSYN VIOLETA 3/0 (2) 70CM HR26B(M)RCP	G2022525	MONOSYN VIOLETA 2/0 (3) 120CM HR26 (M)RCP
C2022358	MONOSYN VIOLETA 2/0 (3) 70CM HR26B(M)RCP	G2022526	MONOSYN VIOLETA 0 (3,5) 120CM HR26 (M)RCP
C2022365	MONOSYN VIOLETA 3/0 (2) 70CM DRC26 (M)RCP	G2022620	MONOSYN VIOLETA 2/0 (3) 70CM FR26 (M).RCP
C2022366	MONOSYN VIOLETA 2/0 (3) 70CM DRC26 (M)RCP	G2022644	MONOSYN VIOLETA 7/0 (0,5)45CM DSMP11M).RCP
C2022376	MONOSYN VIOLETA 2/0 (3) 70CM DRC32 (M)RCP	G2022647	MONOSYN VIOLETA 7/0(0,5)45CM DSMP7(M).RCP
C2022377	MONOSYN VIOLETA 0 (3,5) 70CM DRC32 (M)RCP	G2022803	MONOSYN VIOL 5/0 (1) 70CM 2XHR17 (M).RCP
C2022378	MONOSYN VIOLETA 1 (4) 70CM DRC32 (M) RCP	G2022804	MONOSYN VIOL 4/0 (1,5)70CM 2XHR17 (M).RCP
C2022382	MONOSYN VIOLETA 6/0(0,7)70CM DRC10(M).RCP	G2022810	MONOSYN VIOLETA 5/0 (1) 90CM HR17 (M).RCP
C2022392	MONOSYN VIOLETA 6/0(0,7)70CM DRC12(M).RCP	G2022811	MONOSYN VIOLETA 4/0 (1,5)90CM HR17(M).RCP
C2022403	MONOSYN VIOLETA 5/0 (1) 70CM DRC12(M).RCP	G2022824	MONOSYN VIOLETA 4/0(1,5)90CM 2XHR26M).RCP
C2022404	MONOSYN VIOLETA 4/0 (1,5)70CM2XHRC26(M).RCP	G2022825	MONOSYN VIOLETA 3/0 (2)90CM 2XHR26(M).RCP
C2022405	MONOSYN VIOLETA 3/0(2) 70CM2XHRC26(M).RCP	G2022905	MONOSYN VIOLETA 3/0 (2) 90CM DS19 (M) RCP
C2022406	MONOSYN VIOLETA 3/0 (2) 30CM GR19 (M).RCP	G2023102	MONOSYN UNDYED 6/0(0,7) 45CM DS12(M).RCP
C2022410	MONOSYN VIOLETA 4/0 (1,5)30CM GR19(M).RCP	G2023103	MONOSYN UNDYED 5/0 (1) 45CM DS12(M).RCP
C2022412	MONOSYN VIOLETA 6/0 (0,7)45CM HR22(M).RCP	G2023204	MONOSYN UNDYED 4/0(1,5)45CM DS19 (M) RCP
C2022413	MONOSYN VIOLETA 5/0 (1) 45CM HR22 (M) RCP	G2023205	MONOSYN UNDYED 3/0 (2) 45CM DS19 (M) RCP
C2022415	MONOSYN VIOLETA 3/0 (2) 45CM HR22 (M) RCP	G2023210	MONOSYN UNDYED 3/0 (2) 90CM DS24 (M)RCP
C2022419	MONOSYN VIOLETA 5/0 (1) 45CM DS16 (M).RCP	G2023214	MONOSYN UNDYED 4/0 (1,5) 70CM DS24(M)RCP
C2022420	MONOSYN VIOLETA 4/0(1,5)45CM DS16 (M).RCP	G2023215	MONOSYN UNDYED 3/0 (2) 70CM DS24 (M) RCP
C2022421	MONOSYN VIOLETA 3/0 (2) 45CM DS16 (M).RCP	G2023216	MONOSYN UNDYED 2/0 (3) 70CM DS24 (M) RCP
C2022422	MONOSYN VIOLETA 4/0 (1,5) 90CM HR26(M)RCP	G2023224	MONOSYN UNDYED 4/0 (1,5) 70CM HS23(M)RCP
C2022423	MONOSYN VIOLETA 5/0 (1) 90CM HR26 (M) RCP	G2023225	MONOSYN UNDYED 3/0 (2) 70CM HS23 (M) RCP

B | BRAUN

INSTRUÇÕES DE USO – Fio de Sutura Absorvível Monosyn®

C2022424	MONOSYN VIOLETA 3/0 (2) 120CM HR26 (M)RCP	G2023235	MONOSYN UNDYED 3/0 (2) 70CM HS37 (M) RCP
C2022425	MONOSYN VIOLETA 3/0 (2) 90CM HR26 (M) RCP	G2023236	MONOSYN UNDYED 2/0 (3) 70CM HS37 (M)RCP
C2022426	MONOSYN VIOLETA 2/0 (3) 90CM HR26 (M) RCP	G2023237	MONOSYN UNDYED 0 (3,5) 70CM HS37 (M) RCP
C2022430	MONOSYN VIOLETA 4/0 (1,5)90CM2XHRC22(M).RCP	G2023240	MONOSYN UNDYED 2/0 (3) 70CM HS26 (M) RCP
C2022431	MONOSYN VIOLETA 3/0(2) 90CM2XHRC22(M).RCP	G2023243	MONOSYN UNDYED 2/0 (3) 70CM HS37S (M)RCP
C2022432	MONOSYN VIOLETA 6/0 (0,7)45CM DSMP13M).RCP	G2023248	MONOSYN UNDYED 1 (4) 90CM HS40 (M) RCP
C2022433	MONOSYN VIOLETA 5/0 (1)45CM DSMP13(M).RCP	G2023263	MONOSYN UNDYED 5/0 (1) 70CM HS18 (M) RCP
C2022434	MONOSYN VIOLETA 4/0 (1,5)45CM DSMP13M).RCP	G2023264	MONOSYN UNDYED 4/0 (1,5) 70CM HS18(M)RCP
C2022435	MONOSYN VIOLETA 3/0(2)70CM 2XHR30 (M).RCP	G2023285	MONOSYN UNDYED 3/0 (2) 70CM GS60 (M).RCP
C2022436	MONOSYN VIOLETA 2/0 (3)70CM 2XHR30(M).RCP	G2023286	MONOSYN UNDYED 2/0 (3) 70CM GS60 (M).RCP
C2022438	MONOSYN VIOLETA 1 (4) 90CM HRN45 (M) RCP	G2023303	MONOSYN UNDYED 4/0(1,5) 45CM DS16(M).RCP
C2022439	MONOSYN VIOLETA 0 (3,5) 90CM HRN35 (M)RCP	G2023403	MONOSYN UNDYED 5/0 (1) 70CM DS19 (M) RCP
C2022440	MONOSYN VIOLETA 3/0 (2)70CM 2XHRC30(M).RCP	G2023404	MONOSYN UNDYED 4/0(1,5)70CM DS19 (M) RCP
C2022441	MONOSYN VIOLETA 2/0 (3)70CM 2XHRC30(M).RCP	G2023405	MONOSYN UNDYED 3/0 (2) 70CM DS19 (M) RCP
C2022444	MONOSYN VIOLETA 4/0 (1,5)45CM DSMP19(M)RCP	G2023406	MONOSYN UNDYED 2/0 (3) 70CM DS19 (M) RCP
C2022445	MONOSYN VIOLETA 3/0 (2) 90CM HR37 (M) RCP	G2023412	MONOSYN UNDYED 6/0 (0,7)70CM DS12(M).RCP
C2022446	MONOSYN VIOLETA 2/0 (3) 90CM HR37 (M) RCP	G2023413	MONOSYN UNDYED 5/0 (1) 70CM DS12 (M).RCP
C2022447	MONOSYN VIOLETA 0 (3,5) 90CM HR37 (M) RCP	G2023423	MONOSYN UNDYED 5/0 (1) 70CM DS16 (M) RCP
C2022448	MONOSYN VIOLETA 1 (4) 90CM HR37 (M) RCP	G2023424	MONOSYN UNDYED 4/0(1,5)70CM DS16 (M) RCP
C2022451	MONOSYN VIOLETA 3/0 (2) 90CM HR37S (M)RCP	G2023425	MONOSYN UNDYED 3/0 (2) 70CM DS16 (M)RCP
C2022456	MONOSYN VIOLETA 2/0 (3) 90CM HR37S(M) RCP	G2023435	MONOSYN UNDYED 3/0 (2) 70CM DS30 (M) RCP
C2022457	MONOSYN VIOLETA 0 (3,5) 90CM HR37S (M)RCP	G2023437	MONOSYN UNDYED 0 (3,5) 70CM DS30 (M) RCP
C2022458	MONOSYN VIOLETA 1 (4) 90CM HR37S (M) RCP	G2023601	MONOSYN UNDY 7/0 (0,5)45CM DSMP13(M).RCP
C2022461	MONOSYN VIOLETA 2/0 (3) 90CM HS37S(M).RCP	G2023602	MONOSYN UNDYED 6/0 (0,7)45CM DSMP13M).RCP
C2022466	MONOSYN VIOLETA 2/0 (3) 90CM HR40S(M) RCP	G2023603	MONOSYN UNDYED 5/0 (1)45CM DSMP13(M).RCP
C2022467	MONOSYN VIOLETA 0 (3,5) 90CM HR40S(M) RCP	G2023604	MONOSYN UNDYED 4/0 (1,5)45CM DSMP13M).RCP

B | BRAUN

INSTRUÇÕES DE USO – Fio de Sutura Absorvível Monosyn®

C2022468	MONOSYN VIOLETA 1 (4) 90CM HR40S (M) RCP	G2023613	MONOSYN UNDYED 5/0(1)45CM DSMP16(M).RCP
C2022477	MONOSYN VIOLETA 0 (3,5) 90CM HS37S (M)RCP	G2023614	MONOSYN UNDYED 4/0 (1,5)45CM DSMP16(M)RCP
C2022478	MONOSYN VIOLETA 1 (4) 90CM HS37S (M) RCP	G2023623	MONOSYN UNDYED 5/0 (1) 45CM DSMP19(M)RCP
C2022485	MONOSYN VIOLETA 3/0 (2) 90CM HR26S (M)RCP	G2023624	MONOSYN UNDYED 4/0 (1,5)45CM DSMP19(M)RCP
C2022486	MONOSYN VIOLETA 2/0 (3) 90CM HR26S (M)RCP	G2023625	MONOSYN UNDYED 3/0 (2) 45CM DSMP19(M)RCP
C2022487	MONOSYN VIOLETA 0 (3,5) 90CM HR26S (M)RCP	G2023627	MONOSYN UNDYED 4/0 (1,5)70CM DSMP19(M)RCP
C2022488	MONOSYN VIOLETA 1 (4) 90CM HR26S (M) RCP	G2023628	MONOSYN UNDYED 3/0 (2) 70CM DSMP19(M)RCP
C2022496	MONOSYN VIOLETA 2/0 (3) 90CM HR30 (M) RCP	G2023635	MONOSYN UNDYED 3/0 (2) 70CM DSMP24(M)RCP
C2022497	MONOSYN VIOLETA 0 (3,5) 90CM HR30 (M) RCP	G2023636	MONOSYN UNDYED 2/0 (3) 70CM DSMP24(M)RCP
C2022503	MONOSYN VIOLETA 5/0 (1) 45CM DS19(M)RCP	G2023641	MONOSYN UNDYED 7/0 (0,5)45CM DSMP11M).RCP
C2022504	MONOSYN VIOLETA 4/0(1,5)45CM DS19 (M) RCP	G2023642	MONOSYN UNDYED 6/0 (0,7)45CM DSMP11M).RCP
C2022505	MONOSYN VIOLETA 3/0 (2) 45CM DS19 (M) RCP	G2023647	MONOSYN UNDYED 7/0(0,5)45CM DSMP7(M).RCP
C2022507	MONOSYN VIOLETA 0 (3,5) 90CM HRC26(M) RCP	G2023701	MONOSYN UNDYED 3/0 (2) 70CM DGMP19 RCP
C2022508	MONOSYN VIOLETA 1 (4) 90CM HRC26 (M) RCP	G2023702	MONOSYN UNDYED 4/0 (1,5) 45CM DGMP13.RCP
C2022516	MONOSYN VIOLETA 2/0 (3) 90CM HRC37S(M)RCP	G2023703	MONOSYN UNDYED 4/0 (1,5) 45CM DGMP16.RCP
C2022517	MONOSYN VIOLETA 0 (3,5) 90CM HRC37S(M)RCP	G2023704	MONOSYN UNDYED 4/0 (1,5) 45CM DGMP19 RCP
C2022518	MONOSYN VIOLETA 1 (4) 90CM HRC37S (M) RCP	G2023706	MONOSYN UNDYED 5/0 (1) 45CM DGMP13 .RCP
C2022519	MONOSYN VIOLETA 3/0 (2) 120CM HR22(M) RCP	X2022002	MONOSYN VIOLETA 6/0 (0,7)70CM HR17(M).RCP
C2022520	MONOSYN VIOLETA 2/0 (3) 120CM HR22 (M)RCP	X2022003	MONOSYN VIOLETA 5/0 (1) 70CM HR17 (M) RCP
C2022524	MONOSYN VIOLETA 4/0 (1,5)120CM HR26(M)RCP	X2022004	MONOSYN VIOLETA 4/0 (1,5) 70CM HR17(M)RCP
C2022525	MONOSYN VIOLETA 2/0 (3) 120CM HR26 (M)RCP	X2022005	MONOSYN VIOLETA 3/0 (2) 70CM HR17 (M) RCP
C2022526	MONOSYN VIOLETA 0 (3,5) 120CM HR26(M)RCP	X2022007	MONOSYN VIOLETA 6/0 (0,7)70CM HR13(M).RCP
C2022527	MONOSYN VIOLETA 0 (3,5) 90CM HRC40S(M)RCP	X2022008	MONOSYN VIOLETA 5/0 (1) 70CM HR13 (M).RCP
C2022528	MONOSYN VIOLETA 1 (4) 90CM HRC40S (M) RCP	X2022014	MONOSYN VIOLETA 4/0 (1,5) 70CM HR22(M)RCP
C2022535	MONOSYN VIOLETA 3/0(2)90CM 2XHR30 (M).RCP	X2022015	MONOSYN VIOLETA 3/0 (2) 70CM HR22 (M) RCP
C2022536	MONOSYN VIOLETA 2/0 (3)90CM 2XHR30(M).RCP	X2022016	MONOSYN VIOLETA 2/0 (3) 70CM HR22 (M) RCP

B | BRAUN

INSTRUÇÕES DE USO – Fio de Sutura Absorvível Monosyn®

C2022563	MONOSYN VIOLETA 5/0(1) 45CM DSMP16(M).RCP	X2022024	MONOSYN VIOLETA 4/0 (1,5) 70CM HR26(M)RCP
C2022578	MONOSYN VIOLETA 1 (4) 120CM HR48 (M) RCP	X2022025	MONOSYN VIOLETA 3/0 (2) 70CM HR26 (M) RCP
C2022582	MONOSYN VIOLETA 5/0 (1) 45CM 2XDR8(M).RCP	X2022026	MONOSYN VIOLETA 2/0 (3) 70CM HR26 (M) RCP
C2022592	MONOSYN VIOLETA 3/0 (2) 120CM FR26 .RCP	X2022027	MONOSYN VIOLETA 0 (3,5) 70CM HR26 (M) RCP
C2022601	MONOSYN VIOLETA 6/0 (0,7)45CM DSMP11M).RCP	X2022028	MONOSYN VIOLETA 1 (4) 70CM HR26 (M) RCP
C2022602	MONOSYN VIOLETA 5/0 (1)45CM DSMP11(M).RCP	X2022035	MONOSYN VIOLETA 3/0 (2) 70CM HR30 (M) RCP
C2022606	MONOSYN VIOLETA 5/0 (1) 90CM FR13 (M).RCP	X2022036	MONOSYN VIOLETA 2/0 (3) 70CM HR30 (M) RCP
C2022607	MONOSYN VIOLETA 4/0(1,5)90CM FR13 (M).RCP	X2022037	MONOSYN VIOLETA 0 (3,5) 70CM HR30 (M) RCP
C2022608	MONOSYN VIOLETA 7/0 (0,5)45CM DSMP13M).RCP	X2022038	MONOSYN VIOLETA 1 (4) 70CM HR30 (M) RCP
C2022610	MONOSYN VIOLETA 5/0 (1) 90CM FR17 (M).RCP	X2022045	MONOSYN VIOLETA 3/0 (2) 70CM HR37 (M) RCP
C2022611	MONOSYN VIOLETA 4/0(1,5)90CM FR17 (M).RCP	X2022046	MONOSYN VIOLETA 2/0 (3) 70CM HR37 (M) RCP
C2022614	MONOSYN VIOLETA 5/0 (1) 90CM FR22 (M).RCP	X2022047	MONOSYN VIOLETA 0 (3,5) 70CM HR37 (M) RCP
C2022615	MONOSYN VIOLETA 4/0(1,5)90CM FR22 (M).RCP	X2022048	MONOSYN VIOLETA 1 (4) 70CM HR37 (M) RCP
C2022616	MONOSYN VIOLETA 5/0 (1) 70CM HR17B(M).RCP	X2022066	MONOSYN VIOLETA 2/0 (3) 70CM HR40S (M)RCP
C2022618	MONOSYN VIOLETA 4/0(1,5)70CM FR26 (M).RCP	X2022067	MONOSYN VIOLETA 0 (3,5) 70CM HR40S(M) RCP
C2022619	MONOSYN VIOLETA 3/0 (2) 70CM FR26 (M).RCP	X2022068	MONOSYN VIOLETA 1 (4) 70CM HR40S (M) RCP
C2022620	MONOSYN VIOLETA 2/0 (3) 70CM FR26 (M).RCP	X2022076	MONOSYN VIOLETA 2/0 (3) 90CM HR48 (M) RCP
C2022621	MONOSYN VIOLETA 0 (3,5) 70CM FR26 (M).RCP	X2022077	MONOSYN VIOLETA 0 (3,5) 90CM HR48 (M) RCP
C2022623	MONOSYN VIOLETA 5/0 (1)70CM 2XHR17B(M).RCP	X2022078	MONOSYN VIOLETA 1 (4) 90CM HR48 (M) RCP
C2022625	MONOSYN VIOLETA 2/0 (3) 90CM FR26 (M).RCP	X2022085	MONOSYN VIOLETA 3/0 (2) 70CM HR26S (M)RCP
C2022626	MONOSYN VIOLETA 4/0 (1,5)70CM 2XHR17BM.RCP	X2022086	MONOSYN VIOLETA 2/0 (3) 70CM HR26S (M)RCP
C2022629	MONOSYN VIOLETA 2/0 (3) 70CM FR40 (M).RCP	X2022087	MONOSYN VIOLETA 0 (3,5) 70CM HR26S (M)RCP
C2022630	MONOSYN VIOLETA 0 (3,5) 70CM FR40 (M).RCP	X2022088	MONOSYN VIOLETA 1 (4) 70CM HR26S (M) RCP
C2022632	MONOSYN VIOLETA 4/0 (1,5)70CM 2XHR22BM.RCP	X2022093	MONOSYN VIOLETA 5/0 (1) 70CM DR18 (M) RCP
C2022635	MONOSYN VIOLETA 3/0 (2) 70CM FR36 (M).RCP	X2022094	MONOSYN VIOLETA 4/0(1,5)70CM DR18 (M) RCP
C2022636	MONOSYN VIOLETA 2/0 (3) 70CM FR36 (M).RCP	X2022100	MONOSYN VIOLETA 3/0 (2) 70CM DR22 (M) RCP

B | BRAUN

INSTRUÇÕES DE USO – Fio de Sutura Absorvível Monosyn®

C2022637	MONOSYN VIOLETA 0 (3,5) 70CM FR36 (M).RCP	X2022110	MONOSYN VIOLETA 4/0(1,5)70CM DR22 (M)RCP
C2022638	MONOSYN VIOLETA 4/0 (1,5)90CM 2XHR22BM.RCP	X2022117	MONOSYN VIOLETA 3/0 (2) 70CM DR26 (M) RCP
C2022639	MONOSYN VIOLETA 3/0 (2)70CM 2XHR22B(M).RCP	X2022118	MONOSYN VIOLETA 2/0 (3) 70CM DR26 (M) RCP
C2022643	MONOSYN VIOLETA 4/0 (1,5)70CM HR26B(M)RCP	X2022125	MONOSYN VIOLETA 0 (3,5) 70CM DR32 (M) RCP
C2022644	MONOSYN VIOLETA 7/0 (0,5)45CM DSMP11M).RCP	X2022204	MONOSYN VIOLETA 4/0(1,5)70CM DS19 (M) RCP
C2022647	MONOSYN VIOLETA 7/0(0,5)45CM DSMP7(M).RCP	X2022205	MONOSYN VIOLETA 3/0 (2) 70CM DS19 (M) RCP
C2022648	MONOSYN VIOLETA 6/0(0,7)45CM DSMP7(M).RCP	X2022215	MONOSYN VIOLETA 3/0 (2) 70CM DS24 (M) RCP
C2022649	MONOSYN VIOLETA 3/0 (2)70CM 2XHR26B(M).RCP	X2022216	MONOSYN VIOLETA 2/0 (3) 70CM DS24 (M) RCP
C2022650	MONOSYN VIOLETA 3/0 (2)90CM 2XHR26B(M).RCP	X2022231	MONOSYN VIOLETA 2/0 (3) 70CM DS30 (M) RCP
C2022654	MONOSYN VIOLETA 2/0 (3)70CM 2XHR26B(M).RCP	X2022241	MONOSYN VIOLETA 3/0 (2) 70CM HS26S (M)RCP
C2022655	MONOSYN VIOLETA 5/0 (1) 45CM PR13B(M).RCP	X2022247	MONOSYN VIOLETA 2/0 (3) 70CM HS37S (M)RCP
C2022659	MONOSYN VIOLETA 4/0(1,5)70CM HR22B(M)RCP	X2022249	MONOSYN VIOLETA 1 (4) 70CM HS37S (M) RCP
C2022660	MONOSYN VIOLETA 3/0 (2) 70CM HR22B (M)RCP	X2022306	MONOSYN VIOLETA 2/0 (3) 70CM HRC26 (M)RCP
C2022661	MONOSYN VIOLETA 2/0 (3) 70CM HR22B(M)RCP	X2022310	MONOSYN VIOLETA 6/0(0,7) 70CMHRC13(M).RCP
C2022667	MONOSYN VIOLETA 1 (4) 90CM HRB48 (M) RCP	X2022316	MONOSYN VIOLETA 2/0 (3) 70CM HRC37S(M)RCP
C2022670	MONOSYN VIOLETA 0 (3,5) 90CM FR40 (M).RCP	X2022317	MONOSYN VIOLETA 0 (3,5) 70CM HRC37S(M)RCP
C2022685	MONOSYN VIOLETA 3/0 (2) 70CM DSMP24(M)RCP	X2022318	MONOSYN VIOLETA 1 (4) 70CM HRC37S (M) RCP
C2022688	MONOSYN VIOLETA 4/0(1,5)70CM HR17B(M).RCP	X2022322	MONOSYN VIOLETA 6/0(0,7) 70CMHRC17(M).RCP
C2022689	MONOSYN VIOLETA 3/0 (2)70CM HR17B(M).RCP	X2022323	MONOSYN VIOLETA 5/0 (1) 70CMHRC17 (M).RCP
C2022707	MONOSYN VIOLETA 0 (3,5) 90CM HRB37S(M)RCP	X2022324	MONOSYN VIOLETA 4/0(1,5) 70CMHRC17(M).RCP
C2022708	MONOSYN VIOLETA 1 (4) 90CM HRB37S (M) RCP	X2022325	MONOSYN VIOLETA 3/0 (2) 70CMHRC17 (M).RCP
C2022714	MONOSYN VIOLETA 3/0 (2)120CM SKR19(M).RCP	X2022336	MONOSYN VIOLETA 2/0 (3) 70CM HRC30S(M)RCP
C2022715	MONOSYN VIOLETA 3/0 (2) 30CM SKR26(M).RCP	X2022343	MONOSYN VIOLETA 5/0 (1) 70CMDRC18 (M).RCP
C2022716	MONOSYN VIOLETA 2/0 (3)30CM SKR26(M) .RCP	X2022344	MONOSYN VIOLETA 4/0(1,5) 70CMDRC18(M).RCP
C2022717	MONOSYN VIOLETA 3/0 (2)120CM SKR26(M).RCP	X2022354	MONOSYN VIOLETA 4/0(1,5) 70CM DRC22(M)RCP
C2022718	MONOSYN VIOLETA 2/0 (3)120CM SKR26(M).RCP	X2022355	MONOSYN VIOLETA 3/0 (2) 70CM DRC22 (M)RCP

B | BRAUN

INSTRUÇÕES DE USO – Fio de Sutura Absorvível Monosyn®

C2022724	MONOSYN VIOLETA 4/0 (1,5)70CM2XHRC17(M).RCP	X2022366	MONOSYN VIOLETA 2/0 (3) 70CM DRC26 (M)RCP
C2022725	MONOSYN VIOLETA 3/0(2) 70CM2XHRC17(M).RCP	X2022392	MONOSYN VIOLETA 6/0(0,7)70CM DRC12(M).RCP
C2022727	MONOSYN VIOLETA 3/0 (2)90CM 2XFR26(M).RCP	X2022403	MONOSYN VIOLETA 5/0(1) 70CM DRC12(M).RCP
C2022729	MONOSYN VIOLETA 3/0(2)90CM 2XFR36(M) .RCP	X2022413	MONOSYN VIOLETA 5/0 (1) 45CM HR22 (M) RCP
C2022730	MONOSYN VIOLETA 2/0 (3)90CM 2XFR36(M).RCP	X2022419	MONOSYN VIOLETA 5/0 (1) 45CM DS16 (M) RCP
C2022731	MONOSYN VIOLETA 0 (3,5)90CM 2XFR36(M).RCP	X2022425	MONOSYN VIOLETA 3/0 (2) 90CM HR26 (M) RCP
C2022734	MONOSYN VIOLETA 4/0(1,5)70CM 2XFR26(M).RCP	X2022426	MONOSYN VIOLETA 2/0 (3) 90CM HR26 (M) RCP
C2022735	MONOSYN VIOLETA 3/0 (2)70CM 2XFR26(M).RCP	X2022433	MONOSYN VIOLETA 5/0(1) 45CM DSMP13(M).RCP
C2022736	MONOSYN VIOLETA 2/0 (3)70CM 2XFR26(M).RCP	X2022434	MONOSYN VIOLETA 4/0 (1,5)45CM DSMP13(M).RCP
C2022740	MONOSYN VIOLETA 2/0 (3)90CM 2XFR26(M).RCP	X2022435	MONOSYN VIOLETA 3/0 (2) 70CM 2XHR30 (M).RCP
C2022783	MONOSYN VIOLETA 3/0 (2)30CM DR18 LOOPM.RCP	X2022444	MONOSYN VIOLETA 4/0 (1,5)45CM DSMP19(M)RCP
C2022790	MONOSYN VIOLETA 3/0 (2)70CM 2XDR26(M).RCP	X2022446	MONOSYN VIOLETA 2/0 (3) 90CM HR37 (M) RCP
C2022800	MONOSYN VIOLETA 5/0(1)70CM 2XHR13 (M).RCP	X2022447	MONOSYN VIOLETA 0 (3,5) 90CM HR37 (M) RCP
C2022801	MONOSYN VIOLETA 6/0(0,7)70CM2XHR13(M).RCP	X2022466	MONOSYN VIOLETA 2/0 (3) 90CM HR40S(M) RCP
C2022803	MONOSYN VIOLETA 5/0 (1)70CM 2XHR17(M).RCP	X2022467	MONOSYN VIOLETA 0 (3,5) 90CM HR40S(M) RCP
C2022804	MONOSYN VIOLETA 4/0(1,5)70CM 2XHR17(M).RCP	X2022468	MONOSYN VIOLETA 1 (4) 90CM HR40S (M) RCP
C2022805	MONOSYN VIOLETA 3/0(2)70CM 2XHR17 (M).RCP	X2022469	MONOSYN VIOLETA 2 (5) 90CM HR40S (M) .RCP
C2022810	MONOSYN VIOLETA 5/0 (1) 90CM HR17 (M).RCP	X2022485	MONOSYN VIOLETA 3/0 (2) 90CM HR26S (M)RCP
C2022811	MONOSYN VIOLETA 4/0 (1,5)90CM HR17(M).RCP	X2022486	MONOSYN VIOLETA 2/0 (3) 90CM HR26S (M)RCP
C2022814	MONOSYN VIOLETA 4/0(1,5)70CM 2XHR22(M).RCP	X2022487	MONOSYN VIOLETA 0 (3,5) 90CM HR26S (M)RCP
C2022815	MONOSYN VIOLETA 3/0 (2)70CM 2XHR22(M).RCP	X2022488	MONOSYN VIOLETA 1 (4) 90CM HR26S (M) RCP
C2022823	MONOSYN VIOLETA 4/0(1,5)70CM 2XHR26(M).RCP	X2022504	MONOSYN VIOLETA 4/0(1,5)45CM DS19 (M) RCP
C2022824	MONOSYN VIOLETA 4/0(1,5)90CM 2XHR26(M).RCP	X2022517	MONOSYN VIOLETA 0 (3,5) 90CM HRC37S(M)RCP
C2022825	MONOSYN VIOLETA 3/0 (2)90CM 2XHR26(M).RCP	X2022518	MONOSYN VIOLETA 1 (4) 90CM HRC37S (M) RCP
C2022826	MONOSYN VIOLETA 2/0 (3)90CM 2XHR26(M).RCP	X2022528	MONOSYN VIOLETA 1 (4) 90CM HRC40S (M) RCP
C2022829	MONOSYN VIOLETA 6/0(0,7)90CM 2XDR10(M).RCP	X2022619	MONOSYN VIOLETA 3/0 (2) 70CM FR26 (M).RCP

B | BRAUN

INSTRUÇÕES DE USO – Fio de Sutura Absorvível Monosyn®

C2022830	MONOSYN VIOLETA 5/0 (1)90CM 2XDR12(M).RCP	X2022620	MONOSYN VIOLETA 2/0 (3) 70CM FR26 (M).RCP
C2022832	MONOSYN VIOLETA 6/0 (0,7)70CM 2XDRC12M.RCP	X2022621	MONOSYN VIOLETA 0 (3,5) 70CM FR26 (M).RCP
C2022835	MONOSYN VIOLETA 3/0 (2)70CM 2XHR26(M).RCP	X2022629	MONOSYN VIOLETA 2/0 (3) 70CM FR40 (M).RCP
C2022836	MONOSYN VIOLETA 2/0 (3)70CM 2XHR26(M).RCP	X2022783	MONOSYN VIOLETA 3/0 (2)30CM DR18 LOOPM.RCP
C2022845	MONOSYN VIOLETA 5/0 (1)70CM 2XDRC12(M).RCP	X2022801	MONOSYN VIOLETA 6/0(0,7)70CM2XHR13(M).RCP
C2022854	MONOSYN VIOLETA 6/0(0,7)70CM 2XDR12M).RCP	X2022803	MONOSYN VIOL 5/0 (1) 70CM 2XHR17 (M).RCP
C2022863	MONOSYN VIOLETA 2/0 (3)70CM 2XDR32(M).RCP	X2022804	MONOSYN VIOL 4/0 (1,5)70CM 2XHR17 (M).RCP
C2022885	MONOSYN VIOLETA 6/0(0,7)45CM HR13FFM).RCP	X2022805	MONOSYN VIOLETA 3/0 (2)70CM 2XHR17(M).RCP
C2022904	MONOSYN VIOLETA 4/0(1,5)90CM DS19 (M) RCP	X2022814	MONOSYN VIOLETA 4/0(1,5)70CM 2XHR22M).RCP
C2022905	MONOSYN VIOLETA 3/0 (2) 90CM DS19 (M) RCP	X2022815	MONOSYN VIOLETA 3/0 (2)70CM 2XHR22(M).RCP
C2022914	MONOSYN VIOLETA 4/0(1,5)90CM 2XHR22M).RCP	X2022823	MONOSYN VIOLETA 4/0(1,5)70CM 2XHR26M).RCP
C2022915	MONOSYN VIOLETA 3/0 (2)90CM 2XHR22(M).RCP	X2022824	MONOSYN VIOL 4/0 (1,5)90CM 2XHR26 (M).RCP
C2022934	MONOSYN VIOLETA 5/0 (1)70CM HRC13B(M).RCP	X2022825	MONOSYN VIOL 3/0 (2) 90CM 2XHR26 (M).RCP
C2022943	MONOSYN VIOLETA 4/0 (1,5)70CMHRC17B(M).RCP	X2022826	MONOSYN VIOL 2/0 (3) 90CM 2XHR26 (M).RCP
C2023001	MONOSYN UNDYED 3/0(2)70CM HR37 (M) RCP	X2022835	MONOSYN VIOL 3/0 (2) 70CM 2XHR26 (M).RCP
C2023003	MONOSYN UNDYED 5/0 (1) 70CM HR17 (M).RCP	X2022836	MONOSYN VIOLETA 2/0 (3)70CM 2XHR26(M).RCP
C2023004	MONOSYN UNDYED 4/0(1,5) 70CM HR17(M).RCP	X2022914	MONOSYN VIOLETA 4/0(1,5)90CM 2XHR22M).RCP
C2023005	MONOSYN UNDYED 3/0 (2) 70CM HR17 (M).RCP	X2022915	MONOSYN VIOLETA 3/0 (2)90CM 2XHR22(M).RCP
C2023006	MONOSYN UNDYED 2/0 (3) 70CM HR17 (M).RCP	X2023204	MONOSYN UNDYED 4/0(1,5)45CM DS19 (M) RCP
C2023007	MONOSYN UNDYED 6/0(0,7) 70CM HR13(M).RCP	X2023205	MONOSYN UNDYED 3/0 (2) 45CM DS19 (M) RCP
C2023008	MONOSYN UNDYED 5/0 (1) 70CM HR13 (M).RCP	X2023214	MONOSYN UNDYED 4/0(1,5)70CM DS24 (M) RCP
C2023009	MONOSYN UNDYED 4/0(1,5) 70CM HR13(M).RCP	X2023215	MONOSYN UNDYED 3/0 (2) 70CM DS24 (M) RCP
C2023011	MONOSYN UNDYED 1 (4) 90CM DR48 (M) RCP	X2023216	MONOSYN UNDYED 2/0 (3) 70CM DS24 (M) RCP
C2023014	MONOSYN UNDYED 4/0 (1,5) 70CM HR22(M)RCP	X2023224	MONOSYN UNDYED 4/0 (1,5) 70CM HS23(M)RCP
C2023015	MONOSYN UNDYED 3/0 (2) 70CM HR22 (M) RCP	X2023225	MONOSYN UNDYED 3/0 (2) 70CM HS23 (M) RCP
C2023016	MONOSYN UNDYED 2/0 (3) 70CM HR22 (M) RCP	X2023226	MONOSYN UNDYED 2/0 (3) 70CM HS23 (M) RCP

B | BRAUN

INSTRUÇÕES DE USO – Fio de Sutura Absorvível Monosyn®

C2023024	MONOSYN UNDYED 4/0 (1,5) 70CM HR26(M)RCP	X2023238	MONOSYN UNDYED 1 (4) 70CM HS37 (M) RCP
C2023025	MONOSYN UNDYED 3/0 (2) 70CM HR26 (M) RCP	X2023239	MONOSYN UNDYED 3/0 (2) 70CM HS26 (M) RCP
C2023026	MONOSYN UNDYED 2/0 (3) 70CM HR26 (M) RCP	X2023240	MONOSYN UNDYED 2/0 (3) 70CM HS26 (M) RCP
C2023037	MONOSYN UNDYED 0 (3,5) 70CM HR30 (M) RCP	X2023248	MONOSYN UNDYED 1 (4) 90CM HS40 (M) RCP
C2023045	MONOSYN UNDYED 0 (3,5) 70CM HR37 (M) RCP	X2023250	MONOSYN UNDYED 2/0 (3) 70CM HS30 (M) RCP
C2023081	MONOSYN UNDYED 0 (3,5) 90CM HR37S (M)RCP	X2023251	MONOSYN UNDYED 0 (3,5) 70CM HS30 (M) RCP
C2023086	MONOSYN UNDYED 3/0 (2) 90CM HRC37S(M)RCP	X2023259	MONOSYN UNDYED 0 (3,5) 90CM HS48 (M) RCP
C2023094	MONOSYN UNDYED 3/0 (2) 70CM HR37S (M)RCP	X2023263	MONOSYN UNDYED 5/0 (1) 70CM HS18 (M) RCP
C2023102	MONOSYN UNDYED 6/0(0,7) 45CM DS12(M).RCP	X2023264	MONOSYN UNDYED 4/0 (1,5) 70CM HS18(M)RCP
C2023103	MONOSYN UNDYED 5/0 (1) 45CM DS12(M).RCP	X2023279	MONOSYN UNDYED 4/0(1,5)70CM GS51 (M).RCP
C2023114	MONOSYN UNDYED 4/0 (1,5) 45CM DS24(M)RCP	X2023280	MONOSYN UNDYED 3/0 (2) 70CM GS51 (M).RCP
C2023115	MONOSYN UNDYED 3/0 (2) 45CM DS24(M)RCP	X2023281	MONOSYN UNDYED 2/0 (3) 70CM GS51 (M).RCP
C2023116	MONOSYN UNDYED 2/0 (3) 45CM DS24(M)RCP	X2023284	MONOSYN UNDYED 4/0(1,5)70CM GS60 (M).RCP
C2023131	MONOSYN UNDYED 4/0 (1,5)45CM GS13(M).RCP	X2023285	MONOSYN UNDYED 3/0 (2) 70CM GS60 (M).RCP
C2023162	MONOSYN UNDYED 5/0 (1)70CM DSMP16(M).RCP	X2023286	MONOSYN UNDYED 2/0 (3) 70CM GS60 (M).RCP
C2023163	MONOSYN UNDYED 4/0 (1,5)70CM DSMP16(M).RCP	X2023403	MONOSYN UNDYED 5/0 (1) 70CM DS19 (M) RCP
C2023181	MONOSYN UNDYED 0 (3,5) 70CM DS24(M)RCP	X2023404	MONOSYN UNDYED 4/0(1,5)70CM DS19 (M) RCP
C2023182	MONOSYN UNDYED 1 (4) 70CM DS24(M) RCP	X2023405	MONOSYN UNDYED 3/0 (2) 70CM DS19 (M) RCP
C2023191	MONOSYN UNDYED 2/0 (3) 70CM DS39(M)RCP	X2023412	MONOSYN UNDYED 6/0 (0,7)70CM DS12(M).RCP
C2023201	MONOSYN UNDYED 2/0 (3) 45CM DS30(M)RCP	X2023413	MONOSYN UNDYED 5/0 (1) 70CM DS12 (M).RCP
C2023204	MONOSYN UNDYED 4/0(1,5)45CM DS19 (M) RCP	X2023414	MONOSYN UNDYED 4/0(1,5) 70CM DS12(M).RCP
C2023205	MONOSYN UNDYED 3/0 (2) 45CM DS19 (M) RCP	X2023423	MONOSYN UNDYED 5/0 (1) 70CM DS16 (M) RCP
C2023207	MONOSYN UNDYED 4/0 (1,5) 70CM DS30(M)RCP	X2023424	MONOSYN UNDYED 4/0(1,5)70CM DS16 (M) RCP
C2023210	MONOSYN UNDYED 3/0 (2) 90CM DS24(M)RCP	X2023425	MONOSYN UNDYED 3/0 (2) 70CM DS16 (M) RCP
C2023214	MONOSYN UNDYED 4/0(1,5)70CM DS24 (M) RCP	X2023435	MONOSYN UNDYED 3/0 (2) 70CM DS30 (M) RCP
C2023215	MONOSYN UNDYED 3/0 (2) 70CM DS24 (M) RCP	X2023437	MONOSYN UNDYED 0 (3,5) 70CM DS30 (M) RCP

B | BRAUN

INSTRUÇÕES DE USO – Fio de Sutura Absorvível Monosyn®

C2023216	MONOSYN UNDYED 2/0 (3) 70CM DS24 (M) RCP	X2023601	MONOSYN UNDY 7/0(0,5) 45CM DSMP13(M).RCP
C2023220	MONOSYN UNDYED 3/0 (2) 70CM FS25 (M).RCP	X2023602	MONOSYN UNDYED 6/0 (0,7)45CM DSMP13M).RCP
C2023224	MONOSYN UNDYED 4/0 (1,5) 70CM HS23(M)RCP	X2023603	MONOSYN UNDYED 5/0 (1)45CM DSMP13(M).RCP
C2023225	MONOSYN UNDYED 3/0 (2) 70CM HS23 (M) RCP	X2023604	MONOSYN UNDYED 4/0 (1,5)45CM DSMP13M).RCP
C2023226	MONOSYN UNDYED 2/0 (3) 70CM HS23 (M) RCP	X2023613	MONOSYN UNDYED 5/0 (1) 45CM DSMP16(M)RCP
C2023229	MONOSYN UNDYED 0 (3,5) 70CM HS26S (M)RCP	X2023614	MONOSYN UNDYED 4/0 (1,5)45CM DSMP16(M)RCP
C2023230	MONOSYN UNDYED 1 (4) 70CM HS26S (M) RCP	X2023623	MONOSYN UNDYED 5/0 (1) 45CM DSMP19(M)RCP
C2023235	MONOSYN UNDYED 3/0 (2) 70CM HS37 (M) RCP	X2023624	MONOSYN UNDYED 4/0 (1,5)45CM DSMP19(M)RCP
C2023236	MONOSYN UNDYED 2/0 (3) 70CM HS37 (M) RCP	X2023625	MONOSYN UNDYED 3/0 (2) 45CM DSMP19(M)RCP
C2023237	MONOSYN UNDYED 0 (3,5) 70CM HS37 (M) RCP	X2023627	MONOSYN UNDYED 4/0 (1,5)70CM DSMP19(M)RCP
C2023238	MONOSYN UNDYED 1 (4) 70CM HS37 (M) RCP	X2023628	MONOSYN UNDYED 3/0 (2) 70CM DSMP19(M)RCP
C2023239	MONOSYN UNDYED 3/0 (2) 70CM HS26 (M) RCP	X2023632	MONOSYN UNDYED 4/0 (1,5)70CM DSMP24(M)RCP
C2023240	MONOSYN UNDYED 2/0 (3) 70CM HS26 (M) RCP	X2023633	MONOSYN UNDYED 3/0 (2) 45CM DSMP24(M)RCP
C2023243	MONOSYN UNDYED 2/0 (3) 70CM HS37S (M)RCP	X2023634	MONOSYN UNDYED 4/0 (1,5)45CM DSMP24(M)RCP
C2023244	MONOSYN UNDYED 0 (3,5) 70CM HS37S (M)RCP	X2023635	MONOSYN UNDYED 3/0 (2) 70CM DSMP24(M)RCP
C2023247	MONOSYN UNDYED 0 (3,5) 90CM HS40 (M) RCP	X2023636	MONOSYN UNDYED 2/0 (3) 70CM DSMP24(M)RCP
C2023248	MONOSYN UNDYED 1 (4) 90CM HS40 (M) RCP	X2023642	MONOSYN UNDYED 6/0 (0,7)45CM DSMP11M).RCP
C2023250	MONOSYN UNDYED 2/0 (3) 70CM HS30 (M) RCP	X2023643	MONOSYN UNDYED 5/0 (1)45CM DSMP11(M).RCP
C2023251	MONOSYN UNDYED 0 (3,5) 70CM HS30 (M) RCP		
C2023258	MONOSYN UNDYED 1 (4) 90CM HS48 (M) RCP		
C2023259	MONOSYN UNDYED 0 (3,5) 90CM HS48 (M) RCP		
C2023263	MONOSYN UNDYED 5/0 (1) 70CM HS18 (M).RCP		
C2023264	MONOSYN UNDYED 4/0 (1,5)70CM HS18(M).RCP		

B | BRAUN

INSTRUÇÕES DE USO – Fio de Sutura Absorvível Monosyn®

SEGURANÇA

Fatores de Risco	Características do produto
Toxicidade	Os materiais utilizados na fabricação são inertes não apresentando riscos de toxicidade, garantindo a segurança do paciente e do profissional que o utilizar.
Incompatibilidade Biológica	A matéria-prima deste produto é de origem sintética, sendo posteriormente hidrolisado pelo organismo humano e absorvido. É necessário, no entanto, ficar atento a possíveis reações de hipersensibilidade aos fios.
Contaminantes residuais	A composição química e a origem dos fios permitem sua posterior absorção, não havendo, portanto, contaminantes residuais.
Infecção e contaminação microbiana	Estes produtos são esterilizados a óxido de etileno estando livres de microorganismos e de pirogênios.
Instabilidade e limitações de características físicas e ergonômicas	Este produto está disponível em diversos tamanhos e espessuras, sendo adequadas para diversos procedimentos de sutura de feridas cirúrgicas.

Sônia Quarterolli Martins
Representante Legal

Rosane Gonçalves Ramos da Costa
Responsável Técnico
CRF/RJ nº 3213